



STFM Annual Spring Conference

April 26 - May 1, 2019
Sheraton Centre Toronto • Toronto, Ontario

stfm.org/annual

DOWNLOAD the APP

Access updates, detailed event information, maps, presenters, and more!

Search STFM in your app store.

Conference Wifi

Network: Sheraton_Conference

Password: STFM19

Welcome! With more than 400 presentations, this year's STFM Annual Spring Conference provides many opportunities to learn and share practical and progressive ideas. Topics include:

- Health equity
- Innovation in curriculum and faculty development
- Achieving the Triple Aim: better care, better health, and lower cost
- Meeting accreditation requirements
- Technology and how it's changing education and care
- Family medicine advocacy and policy
- Interprofessional practice and education
- Emerging technologies
- Promoting student interest in family medicine
- Payment models
- Capacity building, resiliency, and retention of the work force

Our Host City: Toronto, Ontario, Canada

Bonjour et Bienvenue au Congrès de l'American Society of Teachers of Family Medicine. Nous Sommes Ravis de Vous Accueillir à Toronto!

Welcome to Toronto, a continental gateway and international crossroads where more than 100 cultures converge, creating a wealth of dining, entertainment, and sightseeing options for visitors. Beyond city limits are breathtaking attractions, such as Niagara Falls, a renowned wine region, outstanding theatres, and outdoor adventures—all within a short drive.

For more information, visit SeeTorontoNow.com

Recognizing the Indigenous People and Lands of Canada

We would like to acknowledge the Mississaugas of the New Credit on whose territory we are guests. We express our gratitude to them as well as the Wendat [wen-dat], the Anishnaabeg [ah-nish-nah-beg], Haudenosaunee [ho-den-oh-sho-nee], Inuit, and Métis people for their stewardship of the land. The relationship our ancestors and Indigenous Peoples had with each other and with the land are described in the Treaty of Niagara of 1764 and remain important to Canada today.

Network, Engage, Connect

2019 Opening Reception

Sunday, April 28, 5:30–6:30 pm

Lights, Photo Booths, Action! Kick off the 2019 STFM Annual Spring Conference with fun activities and engaging ways to get to know other attendees. After receiving a warm welcome by the indigenous people of Toronto, grab your friends and check out the interactive mirror photo booths with Canadian-themed props. Have your caricature created by a talented local artist, and don't forget to stop by the registration desk early to grab some yummy (and fun!) Canadian themed treats.

Sounds like fun, eh?

Room: Grand Ballroom Foyer

STFM Foundation Silent Auction

Don't miss this unique opportunity to own a piece of STFM history! Stop by the STFM Foundation table, and place your bid on a hand-made "STFM Marathonaki Quilt," crafted by former STFM members Jeff and Marge Stearns. Twenty years of Marathonaki Fun Run/Walk shirts were used to craft this one-of-a-kind heirloom. Bids will be accepted until 5 pm on Tuesday, April 30 with proceeds supporting the STFM Foundation's programs.

Room: Grand Ballroom Foyer

Sunrise Yoga

Monday, April 29, 6:30 am

This class is for early risers who like to start their day off with breath and movement. Jessica will take you through a vinyasa flow, cultivating balance, flexibility, strength, and movement. You'll leave the class feeling strong and energized.

Room: Danforth

Lunchtime Zen

Tuesday, April 30, 12:30–1:30 pm

Come find some mid-day zen with a slower-paced class focused on strengthening and stretching. We'll work deeper into the poses, finding our mind-body connection. You'll spend the rest of the day feeling centered and empowered.

Room: Danforth

Mindfulness Meditation Retreats

Sunday, April 28, 3:30–4 pm and Monday, April 29, 4–4:30 pm

Pause the constant “doing” and enjoy a moment of “being.” Explore and experience guided mindfulness meditation in these free drop-in sessions. These 30-minute sessions will be led by Dr Timothy Riley. Please arrive on time to avoid disrupting the sessions.

Room: Forest Hill

STFM Foundation Marathonaki Fun Run/Walk

Tuesday, April 30, 6:15 am

Socialize with colleagues, get some exercise, and raise money for the STFM Foundation at the STFM Foundation Marathonaki Fun Run/Walk. A \$50 tax deductible donation is suggested, although you are not required to donate to participate. All walkers and runners will receive a commemorative t-shirt (while supplies last)!

To sign up, go to stfm.org/foundation/donate.

Special thanks to the College of Family Physicians Canada for their sponsorship of this year’s event.

Room: Runners/Walkers will meet at the STFM registration desk.

STFM Movie Night—“No Mas Bebés”

Tuesday, April 30, 8 pm

No Más Bebés tells the story of a little-known but landmark event in reproductive justice, when a small group of Mexican immigrant women sued county doctors, the state, and the US government after being sterilized while giving birth at Los Angeles County-USC Medical Center during the late 1960s and early 1970s. Set against a debate over the impact of Latino immigration and overpopulation, and the birth of a movement for Chicana rights and reproductive choice, *No Más Bebés* revisits a powerful story that still resonates today. The movie will be followed by audience discussion and reflection with a moderator and special guests.

Room: City Hall Room

Annual Spring Conference Dance Party

Tuesday, April 30, 9 pm–Midnight

Celebrate with conference friends on the dance floor to the musical stylings of the University of Toronto faculty cover band “*Slice of Life*” (sliceoflifeband.com). This will definitely be a once-in-a-lifetime party, so don’t miss it!

Room: Dominion Ballroom

Network, Engage, Connect

Teach & Transform With STFM Products and Services

Visit with STFM staff and member leaders to learn more about specific STFM products and services that can help you teach and transform your departments and programs.

Sunday, April 28, 1:15–2:15 pm: Online Courses and Teaching Resources

Monday, April 29, 10–11 am: Preceptor Expansion Initiative, Health Equity, and Underrepresented in Medicine (URM)

Tuesday, April 30, 10–11 am: Fellowships, Research, and Publications

Room: Osgoode Ballroom Foyer

Toronto Blue Jays Discounted Baseball Tickets for STFM Attendees

Friday-Sunday, April 26, 27, 28

Join your colleagues at a Blue Jays game as they take on the Oakland Athletics for a home series.

Tickets are available here: mlb.com/bluejays (Discount code for STFM attendees: STFM19)

Toronto Theater Scene

The Toronto Theatre District contains the largest concentration of stage theatres in Canada, hosting large touring Broadway and West End productions regularly.

For shows and tickets, visit: toronto-theatre.com

STFM Annual Poetry and Prose Contest and Reading

Saturday, April 27, 6:45–8 pm

Join the STFM Ethics and Humanities Collaborative and winning poets and prose readers as they present the 2019 STFM Annual Poetry and Prose session: “Of Medicine and Mirth: Expressions of Joy or Humor in Practice.”

Room: City Hall Room

Special Optional Events

Meeting of STFM Collaborative Leaders and Board of Directors

Saturday, April 27, 5–6 pm

At this meeting, Collaborative Leaders will meet their STFM Board Liaisons and learn more about resources available to STFM.

Room: Civic Ballroom North

Conference Orientation

Saturday, April 27, 6–6:45 pm

Join conference attendees, as well as STFM Board and Committee members, as we preview the 2019 conference and all that it has to offer! This is a fun, informal, and open forum for questions and networking.

Room: Dominion Ballroom

CFPC Seminars

The following presentations were planned in cooperation with the Society of Teachers of Family Medicine and the College of Family Physicians Canada. These seminars are highlighted in the schedule with a (STFM-CFPC) code at the end of the presentation title:

S85: The Family Physician as Advocate

S11: Welcome to the Family: Promoting Interest in Family Medicine

S12: Developing Foundational Competencies for Medical Teachers: A Tale of Two Countries

S66: Developing and Implementing Curricula on Climate Change in Family Medicine Training

S68: Assessment Across Boundaries

S74: US Work on Diversity and Allyship and Canadian Pursuit Of Cultural Competence/Safety/Humility

S48: Medical Cannabinoids Prescribing Guideline: Sorting 'Doobie-ous' Claims With 'High'-Level Evidence

S02: Preceptor-Learner Boundaries: Optimizing Professional, Educational and Personal Relationships

S83: Buffering Adverse Childhood Events and Reducing Chronic Disease: Family Physician as Upstreamist

S10: Addressing Patient Obesity

S01: Resident Learner Involvement in Medical Aid in Dying

Special Optional Events cont.

NIDA Seminars

The following presentations are supported by the National Institute on Drug Abuse (NIDA):

PR09: Buprenorphine Waiver Training for Family Medicine Faculty: Empowering Training Programs to Address the Opioid Epidemic

W14: Choose Your Own Adventure for HOT Topics in Addiction and Chronic Pain: Pick 3 of 10 Stations to Delve Deeper!

S88: Using Clinical Decision Support to Increase Family Physician Management of Opioid Use Disorder

STFM Collaborative and Special Project Team Meetings

Monday, April 29, 7:15–8:15 am (Breakfast Discussion Tables)

Monday, April 29, 12:30–1:30 pm (Boxed Lunch)

Tuesday, April 30, 12:30–1:30 pm (Open Lunch)

These meetings are open to all members who would like to get involved.

Room: See list of meetings/rooms on pages 85-87.

Conference Presentation Categories

The STFM Annual Spring Conference offers a variety of categories and formats to satisfy attendees' differing needs. Here is a brief overview of the type and length of sessions available:

Preconference Workshop

An interactive, skill-building session scheduled the day before the conference begins and requiring more participant time than other conference formats—limited registration

Time: 4–8 hours

Workshop

A participatory, task-oriented, small-group educational experience directed toward the acquisition, demonstration, construction, and/or synthesis of specific knowledge, skills, and/or attitudes

Time: 90 minutes

Panel Discussion

A moderated, interactive session that brings together three-to-five expert panelists to engage participants in discussion about an innovative or provocative topic in family medicine education

Time: 60 minutes

Seminar

An interactive session requiring active audience engagement and focusing on dissemination and discussion of an innovative educational, administrative, research, career development, or clinical topics

Time: 60 minutes

Lecture-Discussion

A 20–25 minute presentation, followed by 5–10 minutes of participant interaction and/or discussion about a curricular, teaching, administration, or faculty development topic or project, requiring active audience engagement

Time: 30 minutes each with two paired presentations presented consecutively during each session

Completed Scholarly Project

A 15-minute presentation wherein presenters briefly describe implementation and outcomes of a completed innovative educational, administrative, career development, or clinical program/project, requiring active audience engagement limited to a question and answer format

Time: 15 minutes each (10 minutes for presentation, 5 minutes for discussion); Multiple presentations are grouped by topic and presented consecutively in each session.

Completed Research Project

These sessions focus on research submissions that critically evaluate and test completed interventions in education, process of care, patient-oriented outcomes, and quality of care.

Time: 15 minutes each (10 minutes for presentation, 5 minutes for discussion); Multiple presentations grouped by topic are presented consecutively in each session.

Distinguished Paper: 45 minutes (30 minutes for presentation, 15 minutes for questions and discussions)

Conference Presentation Categories cont.

Scholarly Topic Roundtable Discussion

A roundtable presentation wherein 10 participants share ideas, experiences, or projects pertinent to family medicine education, clinical care, research, or management. This presentation occurs in small group format, scheduled concurrently with other presentations during the continental breakfast in the general session ballroom.

Time: 50 minutes (including breakfast)

Developing Scholarly Project Poster

An opportunity to view and discuss an innovative educational or curricular project pertinent to family medicine in an early stage of development

Presenters will be assigned to a 60-minute poster session.

Completed Scholarly Project Poster

An opportunity to view and discuss implementation and results of a completed innovative educational or curricular project pertinent to family medicine

Presenters will be assigned to a 60-minute poster session.

Completed Research Poster

An opportunity to view quality of care studies and discuss investigators' completed original research

Presenters will be assigned to a 60-minute poster session.

Behavioral Science/Family Systems Educator Fellows' Posters

An opportunity to view fellows' year-long project and discuss on-going results and outcomes

Presenters will be assigned to a 60-minute poster session.

Emerging Leaders Fellows' Posters

An opportunity to view fellows' year-long project and discuss on-going results and outcomes

Presenters will be assigned to a 60-minute poster session.

Conference Presentations

A full listing of conference presentations, including dates, times, titles, presenters, abstracts, and objectives, is available in the conference mobile app and online at stfm.org/annual.

Preconference Workshops



Additional fees may apply; Lunch not included unless otherwise noted.

Friday, April 26

8 am–5 pm

PR01: Point-of-Care Ultrasound for the Family Medicine Physician (PART I)

Room: Simcoe/Dufferin

Saturday, April 27

7:30 am–5:30 pm

Conference Registration

Room: Concourse Foyer (Conference Registration will move to Grand Ballroom Foyer on Sunday)

8 am–5 pm

PR01: Point-of-Care Ultrasound for the Family Medicine Physician (PART II; Continued From Friday, April 26)

Room: Simcoe/Dufferin

PR02: Achieving Equity in the Workforce: Exploring the Very Low and Declining Rates of Black Males in Medicine

Room: Civic Ballroom South (Lunch will be provided)

8 am–3 pm

PR03: STFM Faculty for Tomorrow Workshop for Residents

Room: Dominion North

1–5 pm

PR04: Increasing Student Choice of Family Medicine: Getting to 25 by 2030

Room: Dominion South

PR05: Dermoscopy: Expanding “Scope” of Practice and Preventing Skin Cancer Deaths

Room: Kent

PR06: Learning Faculty Development Skills in Mentorship, Coaching, Scholarly Activity, and Wellness: A Toolkit for New Faculty in Family Medicine

Room: Churchill

PR07: Moving From Passive Spectator to Active Participant: Teaching Approaches that Create Lasting Change in Our Learners

Room: Kenora

PR08: Train the Trainers Wellness Curriculum Workshop: Three Schools Collaborate to Share Experiences and Prepare Teachers to Implement Evidence-Based Wellness Strategies for Students, Residents and Faculty

Room: Huron

PR09: Buprenorphine Waiver Training for Family Medicine Faculty: Empowering Training Programs to Address the Opioid Epidemic (Supported by NIDA)

Room: VIP Room

PR10: Designing Programmatic Assessment That Meets Accreditation Requirements: Applying Core Principles and Approaches to Assessment of Learners in Clinical Training

Room: Forest Hill

5–6 pm

Meeting of the STFM Collaborative Leaders and Board of Directors

Room: Civic Ballroom North

6–6:30 pm

Conference Orientation

Room: Dominion North Ballroom

6:45–8 pm

STFM Annual Poetry and Prose Reading

Room: City Hall

Sunday, April 28



7 am–7 pm

Conference Registration and Computer Café

Room: Grand Ballroom Foyer

7:15–8:15 am

Healthy Start Breakfast (Eggs, Muffins, Fruit, Yogurt, Oatmeal, Cereal)

Scholarly Topic Roundtable Presentations (See pages 53-56.)

Room: Grand Ballroom

Opening General Session

8:30–9 am

STFM President's Address: *Beat Steiner, MD, MPH*

Greetings: *Andrea Pfeifle, EdD, Chair, STFM Program Committee*

Room: Grand Ballroom

9–10 am

Advancing the Vision for Diversity and Inclusive Excellence



Alicia Monroe, MD

Baylor College of Medicine

This session will provide a brief discussion of diversity and inclusive excellence. A menu of tools and strategies will be presented that can be used by individuals, programs, and organizations to advance inclusive excellence.

Dr Alicia Monroe serves as provost and senior vice president of Academic and Faculty Affairs, and professor of Family Medicine at Baylor College of Medicine (Baylor), Houston, Texas. In September 2018, Dr Monroe also was appointed as interim designated institutional officer (DIO) for GME. She currently serves as the chair of the Association for American Medical Colleges (AAMC) Advisory Committee on Holistic Review and is a member of the AAMC Board of Directors and Baylor University Board of Regents.

Room: Grand Ballroom

10–10:30 am

Beverage Stations—Visit With Your 2019 Conference Partners

Room: Grand Ballroom Foyer

10:30–11:30 am: Lecture-Discussions

L01A: End-of-Life Options Counseling: What Every Resident Needs to Know

L01B: Delivering Difficult News: A Multimodal Approach to Learning

Room: Simcoe

L02A: Medical Students Matching Into Family Medicine: Trends and Opportunities

L02B: Promoting Student Interest in Family Medicine: Keck School of Medicine Primary Care Program

Room: City Hall

L03A: Using Photovoice to Reflect on Resident Burnout and Resiliency

L03B: Using Digital Storytelling as a Teaching Tool to Enhance Teamwork, Inclusion and Health Equity Advocacy

Room: Yorkville West

L04A: Reviewing the Evidence: Using the National Academy of Science Report to Integrate Abortion Care Services in Primary Care Settings

L04B: Advocacy for Public and Private Health: Self-Induced Abortion—A Tale of Two Organizations

Room: Wentworth

L05A: How Do We Reduce Drug Seeking in the Emergency Department and Improve Compassionate Treatment?

L05B: Every Resident Should Know About Buprenorphine: How to Teach Them and Make it a Reality in Your Clinic

Room: Dominion North

L07A: Inpatient Resident Consult Service for Addiction, Suboxone, and HIV Care

L07B: Growing Proficiency in the Management of Substance Use Disorders: Developing and Disseminating an Addiction Medicine Curriculum in an FQHC-Based Family Medicine Residency Program

Room: Kenora

L16A: Building a Portfolio for Academic Success

L16B: Academic Productivity: Valuing the Clinician Teacher

Room: Dominion South

L67A: Anxiety Care: Increasing Access Through a Shared Medical Appointment Model

L67B: A Cotraining Program in Integrated Care for FM Residents and Postdoc Psychology Fellows: Description of a Cotraining Model and Trainee Reflections

Room: Kent

10:30–11:30 am: Completed Research Projects

SESSION A: Distinguished Papers

CRA1: Understanding the Predictive Value of Medical School Applicants' Rural Characteristics on Eventual Rural Practice

CRA2: Does Shared Decision Making Affect People's Preference, Intent, and Adherence Regarding Colorectal Cancer Screening? Results From the Decision Aid to Technologically Enhance Shared Decision Making (DATES) Study

CRA3: Opioid Use During Pregnancy Increases Postpartum Readmission Rates in Women With and Without Major Obstetric Comorbidities

Room: Sheraton Hall A

SESSION B: Education

CRB1: Scoring Narrative Elements of Medical School Applications: Associations With Acceptance and Subsequent Performance at Five California Schools

CRB2: Effect of Teacher and Trainee Gender Concordance on Teaching Evaluations in Family Medicine: Are Women Disadvantaged?

CRB3: How Communities Change Us: Professional Identity Formation Analysis Utilizing Reflections From a Third-Year Rural and Community Medicine Rotation

CRB4: How Much Money and Time Do Students Invest in Interviewing for Residency Positions? How Do They Decide What to Spend?

Room: Sheraton Hall B

10:30–11:30 am: Completed Scholarly Projects

SESSION A

CSA1: Dermatology Photo Quiz Contest: A Case-Based Primary Care Dermatology Curriculum

CSA2: The New Blended Classroom Format for the Advanced Life Support in Obstetrics (ALSO) Provider Course: Results, Reflections, and Recommendations

CSA3: Goal-Oriented Assessment of Learning: An Individualized Learning Plan for Residents

CSA4: Symptomatic Early Pregnancy: Analysis of a New β -hCG Assay, Ultrasound, and Clinical Outcomes

Room: Provincial South

10:30–11:30 am: Panel Discussion

PD1: The Peer Review Process: Insight From the Editors of Family Medicine Journals

Room: Civic Ballroom North

10:30–11:30 am: Seminars

S02: Preceptor-Learner Boundaries: Optimizing Professional, Educational and Personal Relationships (STFM-CFPC)

Room: Provincial North

S03: The Impact of 2018 CMS Guidelines on Medical Student Documentation

Room: Civic Ballroom South

S04: Teaching Incentives for Primary Care Preceptors: The Good, The Bad, and the Money

Room: Sheraton Hall C

S05: Help Wanted: Addressing Residency Culture Towards Medication-Assisted Treatment

Room: Dufferin

S08: Engaging Residents and Residency Clinics in Community Projects: A Case Study

Room: Huron

S09: Perinatal Substance Abuse: Educating the Next Generation of Physicians in the Midst of an Epidemic

Room: Davenport

S50: Making the Invisible Visible: Exploring Bias Through Art Observation

Room: Leaside

S77: Dealing With Patients Whose Behavior is Racist: Creating a Training Module for a Family Medicine Residency

Room: Elgin

11:45 am–1:15 pm

Networking Luncheon

Greetings From the College of Family Physicians of Canada: *Paul Sawchuk, MD, MBA, President*

Room: Grand Ballroom

1:15–2:15 pm

Poster Session I: Dedicated Time for Poster Presentations (See pages 61-68.)

“Teach & Transform” With STFM Products and Services—Online Courses and Teaching Resources

Room: Osgoode Ballroom and Foyer

2:30–3:30 pm: Lecture-Discussions

L09A: If You Build It, They Will Serve: Developing a Service-Learning Home to Care for the Homeless

L09B: Design and Implementation of a Homeless Health Track

Room: Leaside

L12A: Caring for Homeless Youth: A Successful Community Residency Partnership Built on Service and Learning

L12B: Piloting a Correctional Health Curriculum Through Resident Elective Experiences

Room: Yorkville West

L13A: 'Til Death Do Us Part: What Students Learn About End-of-Life Care From Completing Their Own Personal Advance Directives

L13B: How to Teach Advance Care Planning to Family Physicians

Room: Elgin

2:30–3:30 pm: Lecture-Discussions cont.

L14A: The Art of the Possible: What Have We Learned About Creating an Education Scholarship Grant Program?

L14B: Peer-Reviewed Journals and Predatory Publishers: Author Beware!

Room: Simcoe

L18B: Cultivating Leaders and Inspiring Mentorship Bonds: A How-To Guide on Inspiring Learners to Pursue Family Medicine

Room: Civic Ballroom South (Presented from 3-3:30 pm)

L46A: Teaching About Childhood ADHD in Family Medicine: The Primary Care ADHD Toolkit

Room: Wentworth (Presented from 2:30-3 pm)

L44A: Qualitative Evaluation of the Impact of Oral Health Integration Among Primary Care Training Programs in the United States

L10A: Enhancing a Transitional Care Management Program

Room: Danforth

2:30–3:30 pm: Completed Research Projects

SESSION C: Scholarship

CRC1: From “Check the Box” to “Creative Pursuit:” Program Leadership Perspectives on Research and Scholarship

CRC2: Personal Manuscript Acceptance Rates—Novel Metrics for Self-Assessment in Scholarship

CRC3: Evaluating Predictors of Successful Funding to an Education Development Grant: The Role of the Person and the Project

CRC4: Developing Family Physician Health Equity Leaders: Identifying Statements and Imperatives Deemed Important Through a Delphi Method Approach

Room: Sheraton Hall A

2:30–3:30 pm: Completed Scholarly Projects

SESSION B

CSB1: A Suboxone Bridge Program: Getting Patients From the ED to Recovery

CSB2: Implementation of an Interprofessional Alcohol Screening and Brief Intervention Project to Effect Practice Change in Primary Care Clinics

CSB3: Whole-Person Care for the Seriously Mentally Ill in a Family Medicine Residency Program

CSB4: Development, Implementation, and Evaluation of a Nationwide Screening and Brief Intervention Training Program for Family Medicine Residencies

Room: Sheraton Hall B

2:30–3:30 pm: Panel Discussion

PD4: Racism and Anti-Racist Initiatives in Graduate Medical Education: Updates From the Resident Perspective

Room: Provincial South

2:30–3:30 pm: Seminars

S01: Resident Learner Involvement in Medical Aid in Dying (STFM-CFPC)

Room: Huron

S30: Writing and Submitting Manuscripts for *Family Medicine*

Room: City Hall

S75: “Did My Attending Just Say That?” How to Spot and Tactfully Handle Racism, Sexism, and Other Forms of Discrimination Within the Health Care Setting

Room: Dufferin

S83: Buffering Adverse Childhood Events and Reducing Chronic Disease: The Family Physician as Upstreamist (STFM-CFPC)

Room: Civic Ballroom North

S85: The Family Physician as Advocate (STFM-CFPC)

Room: Provincial North

S86: Navigating Change Without Losing Voices: A Competency and Case-Based Approach to Managing Change and Creating an Inclusive Culture in Departments of Family Medicine

Room: Dominion North

2:30–3:30 pm: Seminars cont.

S87: When Reading More Doesn't Work: Assessment and Remediation of the Resident With Clinical Reasoning Deficits

Room: Kent

S88: Using Clinical Decision Support to Increase Family Physician Management of Opioid Use Disorder (Supported by NIDA)

Room: Dominion South

S89: The Role of Family Physicians in Self-Managed Abortion

Room: Davenport

S90: Resident-Led Milestones: Creating Self-Directed Leaders

Room: Kenora

S91: Beyond the Sandwich and ARCHes—Adding Versatility to Your Feedback Toolbox

Room: Sheraton Hall C

S92: Four Years' Experience With a Medical Scribe Fellowship Program: Bringing Joy of Practice and Joy of Scholarship

Room: Churchill

S93: Teaching Crucial Conversation Skills to Residents

Room: Kensington

3:30–4 pm

Beverage Stations—Visit With Conference Partners and Poster Presenters

Room: Grand Ballroom Foyer and Osgoode Ballroom

Mindfulness Meditation Retreat

Room: Forest Hill

4–5 pm: Lecture-Discussions

L06A: Home Opioid Management Education in Older Adults (SAFE-HOME): Naloxone Awareness Program

L06B: Improving Safety in Patients on Chronic Opioid Therapy With Rapid Cycle Quality Improvement Teams

Room: Churchill

L11A: The Art of Deprescribing

L11B: Use Your Moodle: An Interactive Pharmacotherapy Curriculum

Room: Davenport

L15A: Outcomes of a Scholarly Activity Curriculum for Family Medicine Residents

L15B: How to Hack Your (Scholarly) Life Featuring Letters to the Editor and Publication Tips and Tricks

Room: Simcoe

L17A: RELAY

L17B: Implementation of a Medical School Elective Pathway to Improve Student Exposure to the Science of Health Behavior Change

Room: Leaside

L19A: Patient First: Implementation of a Clinic-Based Curriculum for FM Residents

L19B: There's a Checklist for Everything Else: Developing a Standardized Process for Panel Reassignment

Room: Huron

L20A: Interactive Strategies to Enhance Pediatric Curriculum, Teach Panel Management and Increase Pediatric Visits

L20B: QI Can Do It! How to Please GME Reviewers, Your Program Director, System Leaders, and Engage Your Residents

Room: Kent

4–5 pm: Completed Research Projects

SESSION D: Clinical

CRD1: Exploring Patient Perspectives of Disease Severity: Lessons for Talking to Patients About Prediabetes and Diabetes

CRD2: An Abdominal Obesity Measurement and Intervention Program in Primary Care: A Controlled Pilot Study

CRD3: Sedentary Lifestyle and Cardiovascular Disease Risk: A Healthy Body Mass Index is Not Enough

CRD4: A Nationwide Study of Breast Cancer, Depression, and Multimorbidity in the US: An Increasing Problem Among Women and Men

Room: Sheraton Hall A

4–5 pm: Completed Scholarly Projects

SESSION C

CSC1: Enhancing Research and Scholarly Activities in Family Medicine Residency Training

CSC2: Developing Research Capacity Among Geographically Dispersed Family Medicine Residency Programs: A Regional Approach

CSC3: Identifying and Communicating the Actual Value of Our Work Via a Theory of Impact: Stories From the Field of Education Scholarship in Family Medicine

CSC4: Engaged Research in Family Medicine: Development of a Research Division That Builds Research Cohesiveness Among Strengths Across Faculty Members

Room: Sheraton Hall B

4–5 pm: Panel Discussion

PD3: Equity and Diversity in Family Medicine Leadership—Principles and Strategies in Negotiation—Voices From Family Medicine Leaders

Room: Dominion South

4–5 pm: Seminars

S10: Understanding the Complexities of Obesity, and How These Impact Patient Care (STFM-CFPC)

Room: Provincial North

S12: Developing Foundational Competencies for Medical Teachers: A Tale of Two Countries (STFM-CFPC)

Room: Forest Hill

S13: Addressing Health Disparities Through Tackling Bias in Medical Education

Room: Sheraton Hall C

S14: Show Me the Money—Women and Salary Negotiation

Room: Provincial South

S78: OMG My Patient Has HIV! Primary Care in HIV—A Guide for Family Medicine

Room: Danforth

4–5:30 pm: Workshops

W01: Quality Improvement Projects as Research: A Building Research Capacity (BRC) How-To Workshop

Room: Civic Ballroom North

W02: Sweet Mindfulness: A Chocolate Tasting

Room: Civic Ballroom South

W03: Running Lapse: Interactive Modules for Measuring Specific Patient Safety and Professional Conduct Milestones That Can Be Elusive

Room: Elgin

W04: The Health Equity Curricular Toolkit: A Toolkit for Primary Care and Interprofessional Educators Striving for Health Equity

Room: City Hall

W05: Strategies and Tools to Teach Patient-Centered Interactions: Blending Efficiency and Quality

Room: Yorkville West

W06: Spark Connection: A Quick Way for Underrepresented in Medicine Faculty to Expand Their Professional Support Network and Contacts

Room: Kenora

W08: The Point-of-Care Ultrasound Curriculum Symposium: Curricular Experience and Insights From Multiple Training Programs

Room: Dominion North

W18: From Question to Manuscript—URMM Scholarship

Room: Dufferin

5:30–6:30 pm

Conference Opening Reception

Room: Grand Ballroom Foyer

7 am–5:30 pm

Conference Registration and Computer Café

Room: Grand Ballroom Foyer

6:30–7:30 am

Sunrise Yoga (Beginner and Intermediate Levels Welcome)

Room: Danforth

7:15–8:15 am

Healthy Start Breakfast (Eggs, Muffins, Fruit, Yogurt, Oatmeal, Cereal)
STFM Collaboratives' Networking and Common Interest Discussions
(See page 85.)

Room: Grand Ballroom

8:30–10 am

STFM Awards Program

Greetings From the American Academy of Family Physicians:

John Cullen, MD, President

Room: Grand Ballroom

10–11 am

Beverage Stations; Poster Session II: Dedicated Time for Poster Presentations (See pages 68-75.)

“Teach & Transform” With STFM Products and Services—Preceptor Expansion Initiative and Health Equity/URM

Room: Osgoode Ballroom and Foyer

11:15 am–12:15 pm: Lecture-Discussions

L22A: The Renaissance of Home Visits in Residency Training

L22B: Coadvising: Blending Contributions of Academic and Clinical Advisors

Room: Kenora

L23A: Nurturing the Student, Sustaining the Mission, Increasing the Primary Care Workforce: The VCU International/Inner City/Rural Preceptorship (I2CRP) Program

L23B: Creating a Better Pipeline for Rural Students: A Collaboration Between the UNC Department of Family Medicine and the Office of Rural Initiatives

Room: Huron

11:15 am–12:15 pm: Lecture-Discussions cont.

L24A: Nonpharmacologic Management of Geriatric Dementia:
Music in Medicine and More

L24B: Implementing Telehealth Curriculum in Family Medicine
Residency to Evaluate the Effect on Hospital Encounters in a
Senior Living Facility

Room: Kent

L25A: Capacity Building Through the Toronto Addis Ababa
Academic Collaboration in Family Medicine: A Model of International
Partnership and Innovation in Program Development

L25B: Family Medicine Global Health Experiences: Connecting
Student Interest and Career Exploration

Room: MacKenzie

L26A: EmpowHER: Women in Medicine Support Group to Mentor
Female Resident Physicians

L26B: Quest to Confront Inequity, Racism and Disparities:
It's a Long Road, but We Had to Start Somewhere

Room: Civic Ballroom North

L27A: Residency Promoting Inclusion, Diversity, and Equity:
Curricular Changes to Reduce Racial Discrimination Within Medicine

L27B: Promoting Health Equity Through a Residency Curriculum
Addressing Social and Structural Determinants of Health:
From Clinic to Community and the Capitol

Room: Sheraton Hall C

L41A: Redefining the Patient Continuity Experience:
Emphasizing Continuity Beyond the Delivery

L41B: Forgotten Moms—Family Medicine Physicians and Mothers
of Infants Admitted to the Neonatal Intensive Care Unit (NICU)

Room: Dufferin

11:15 am–12:15 pm: Completed Research Projects

SESSION E: Curtis Hames Award and Best Research Paper Award

CRE1: Curtis Hames Award Winner Presentation: A Patient Centered Approach to Weight Loss Using eHealth Technology

CRE2: STFM Research Paper of the Year Presentation: Delivering Interconception Care During Well Child Visits—An IMPLICIT Network Study

Room: Sheraton Hall A

SESSION F: Health Services

CRF1: Effect of Optimization of the Medical Assistant Role on Volume of Refill Requests

CRF2: Patient Interest in Video Integration Into After-Hours Triage Calls

CRF3: Hot Spotter Neighborhoods: Mapping Primary Care Clinic's Patient Population Using GIS Technology

CRF4: The Incidence, Trend and Survival of Infant Cancer in the United States From 1975 to 2014

Room: Sheraton Hall B

11:15 am–12:15 pm: Completed Scholarly Projects

SESSION D

CSD1: Ultrasound Imaging Knowledge and Skill Acquisition by Family Medicine Residents and Clerkship Students

CSD2: How Are We Actually Doing? Engaging Adolescents in Evaluating and Improving Health Care Services

CSD3: Implementation of an Early Childhood Caries Treatment Program in a Family Medicine Residency Clinic

CSD4: No More NICU: Expanding Faculty Scope of Practice to Provide Neonatal Care

Room: Provincial South

11:15 am–12:15 pm: Panel Discussion

PD2: Applying Education Science to Family Medicine: Stories From the Trenches

Room: Churchill

11:15 am–12:15 pm: Seminars

S16: Advocacy for Health Equity

Room: Leaside

S17: Sharing the Care: Strategies for Team-Based Care From High-Performing Teaching Practices

Room: Simcoe

S18: Going Pro: An Educator's Toolkit for Teaching and Troubleshooting Professionalism

Room: City Hall

S19: Digital Storytelling: An Innovative, Narrative Approach to Enhance Family Medicine Education

Room: Davenport

S20: Teaching One-Minute Preceptor With Real Audio-Recordings: A Simple, Replicable Tool for Faculty Development

Room: Wentworth

S21: One Bourbon, One Scotch, One Beer: Screening for Substance Abuse in the Elderly and What to Do When You Find It

Room: Elgin

S22: Teaching Resiliency: Create a Wellness Toolbox That Fosters Resilience

Room: Dominion South

S23: ABFM Preceptor Performance Improvement Program Pilot—Lessons Learned From Four UGME Institutions

Room: Dominion North

S24: Gimme Five: Five Easy Interactive Methods to Engage Your Learners

Room: Yorkville West

S94: How to Engage Community Preceptors: Lessons Learned From Canada and the United States

Room: Civic Ballroom South

12:30–1:30 pm

Boxed Lunch; Visit With Conference Partners

Open STFM Collaborative and Special Project Team Meetings (See list of meetings on page 86.)

Room: Grand Ballroom

1:45–2:45 pm: Lecture-Discussions

L29A: Going Where There Are No Roads: Promoting Equity Through Rural Curricular Redesign

L29B: Initial Outcomes of a Longitudinal Social Determinants of Health Curriculum for Residents

Room: Huron

L30A: The Quest for Equity in Health Interventions: Can a Rising Tide Raise All Ships?

L30B: Medical Centers and ICE (Immigration and Customs Enforcement): Where Do We Stand and What Should We Do?

Room: Sheraton Hall C

L31A: Eliminating HCV in the Medical Home: Pearls and Panel Session From Across the Nation's FMRP

L31B: Hepatitis C in Primary Care

Room: Elgin

L32A: Saving Prometheus: Hepatitis C Treatment in a Teaching Health Center

L32B: Getting to Zero From the Other Side of the HIV Epidemic—PrEP in Women, Adolescents, PWID, and Rural Areas

Room: Kensington

L33A: Aiming for Long-Term Impact of Implicit Bias Training in an FMR Program

L33B: Countering Harassment, Discrimination and Abuse: A Simulation for Residents

Room: Kent

L34A: Untangling the Web and Residency Resources: One Website at a Time

L34B: New Kid on the Block: A Literature Review of the Use Geographic Information Systems (GIS) to Teach Social Determinants of Health

Room: Simcoe

L55A: Evaluation Manual—An Innovative Guide to Objective Milestone-Based Evaluation of Family Medicine Residents

L55B: Are You Thinking I'm Thinking? A New Approach to the Dreaded CCC

Room: Dufferin

1:45–2:45 pm: Completed Research Projects

SESSION G: Pediatrics

CRG1: Thirdhand Smoke Contamination in a Pediatric Hospital Setting

CRG2: Using the HITSS Screening Tool to Detect Child Abuse in Clinical Settings

CRG3: Preventing Secondhand Smoke Exposure for Infants and Children Living With Individuals Who Smoke: Primary Outcome Data From the Baby's Breath II Study

CRG4: Provider Adoption of an EMR Tool to Address Childhood Obesity in the Primary Care Clinic: A Mixed-Methods Study

Room: Sheraton Hall A

1:45–2:45 pm: Completed Scholarly Projects

SESSION E

CSE1: In Our Hands: A Primary Care Procedures Elective Teaches Medical Students the Scope and Role of Family Medicine

CSE2: Medical Student and Resident Education in Migrant and Seasonal Farmworker Health

CSE3: Lessons From the Trenches: Successes and Challenges in Implementation of a Longitudinal Curriculum in Interprofessional Collaboration

CSE4: Family Medicine Clerkship Students' Experiences With Team-Based Care

Room: Sheraton Hall B

1:45–2:45 pm: Seminars

S25: Changing the Lens on Leadership Challenges

Room: Provincial South

S26: Shifting Department Culture Through Faculty-Led Antiracism Initiatives

Room: Leaside

S27: Pursuit of the Triple Aim Through Interprofessional Collaboration With Pharmacists as Practitioners and Educators: Lessons Learned From a National Survey

Room: Civic Ballroom North

S28: Building a Wisdom Community in Residency to Foster a Resilient, Lifelong Workforce

Room: Wentworth

S29: Handling Death in a Residency Program—Creating a Plan We Hope to Never Need

Room: Yorkville West

S31: The Medical Educator's Toolkit: Educational Strategies Grounded in Evidence

Room: Civic Ballroom South

S32: Solutions for Scholarship: How to Increase Scholarly Activity in Your Community-Based Residency Program

Room: City Hall

S33: “But It Seemed Like We Were on the Same Page...” Integrating Concepts of Intercultural Communication Into Family Medicine Education and Practice

Room: Kenora

S34: Standardizing Resident Education: Utilizing the Family Medicine Residency Curriculum Resource

Room: Dominion North

S35: Examining Racism in Pursuit of Health Equity

Room: Dominion South

S36: Openness, Trust, and Collaboration: Enhancing Resident Leadership Skills With Experiential-Based Learning

Room: Churchill

2:45–3 pm

Transition Break

3–4 pm: Lecture-Discussions

L21A: Extreme Makeover: How Our Family Medicine Inpatient Service Embraced Its Inner Beyonce

L21B: Physician Well-Being: Teaching Resiliency and Office Efficiency

Room: Civic Ballroom North

3–4 pm: Lecture-Discussions cont.

L35A: STFM Innovative Program Award: Incarceration, Health Disparities, and Social Justice: Mitigating a Public Health Crisis

L35B: Leadership and Advocacy through Expeditionary Learning: Can We Teach Leadership?

Room: Provincial South

L37A: Integration and Optimization of Clinical Pharmacists as Clinician-Educators and Faculty Members Within Family Medicine Residency Programs

L37B: Interprofessional Chronic Pain Training in Primary Care: Building Trainee and Patient Confidence

Room: Kent

L38A: Creating a Welcoming Climate for LGBTQ+ Adolescents: A Multidisciplinary Approach

L38B: Incorporating Transgender Care Into an Academic Family Medicine Department: Increasing Capacity for Transgender Care Across the Family Medicine Training Spectrum

Room: Dufferin

L39A: A Faculty Development Initiative to Improve LGBTQ Health Education

L39B: Developing LGBTQ Curricula and Patient Care at an Academic Family Medicine Residency Program

Room: Simcoe

L40A: Delivering Faculty Development Curriculum as an Integral Part of FMOB Fellowship—Birthing the Maternal Child Health Teachers of the Future

L40B: Innovation in a Robust Advanced Maternity Care Track and Outcomes From the Years 2000–2018

Room: Wentworth

L56A: Molding the Millennial Mind: Creating Engaging Lectures for a New Generation of Learners

L56B: Improving Resident Didactics: Implementing an Innovative and Interactive Case-Based Curriculum

Room: Sheraton Hall C

3–4 pm: Completed Research Projects

SESSION H: Behavioral Health

CRH1: Values-Based Behavioral Activation Intervention Among Patients Living With Chronic Pain in an Urban Family Medicine Clinic

CRH2: Pilot Study of Pain Management and Mental Health Treatment in a Family Medicine Residency Clinic

CRH3: Substance Use Disorder Treatment Expansion Program for High-Risk Women

CRH4: Stress in Pregnancy: Improving Stress Screening and Linkage to Services at a Chicago Federally Qualified Health Center (FQHC) System

Room: Sheraton Hall A

3–4 pm: Completed Scholarly Projects

SESSION F

CSF1: Integrating Medicare Wellness Visit Training Into a Redesigned, “Immersive” Geriatrics Rotation

CSF2: Pharmacist-Led Medicare Annual Wellness Visits in a Family Medicine Clinic

CSF3: Interprofessional Chronic Care Management in Family Medicine

CSF4: A Structured, Home-Based Intervention for Complex Patients: Decreasing Acute Care Utilization for High-Cost, High-Need Patients

Room: Sheraton Hall B

3–4 pm: Panel Discussion

PD7: The Clinic First Transition—Fact or Fiction?

Room: Churchill

3–4 pm: Seminars

S37: Training Our Educators: Using the STFM Residency Faculty Fundamentals Certificate Program

Room: Civic Ballroom South

S38: No Quality Without Equity: “M & M” Conferences as a Tool for Equity-Focused Institutional Change

Room: City Hall

S39: Residency Project ADD: Develop a System to Ensure Success

Room: Huron

S40: Teaching Transgender Care in a Family Medicine Residency

Room: Kenora

S41: Teaching Procedural Skills Using Evidence From Educational Research

Room: Dominion North

S42: Introducing Clinical Art Therapy in Residency Education: Meeting Accreditation Requirements Through an Innovative Curriculum in the Visual Arts

Room: Leaside

S43: Tackling QI Work: Trials, Training, and Team Success in Our Residency

Room: Dominion South

S44: Simple Conversations—What Is Your SOCO (Single Overriding Communication Outcome)?

Room: Kensington

S45: Empowering Learners to Approach Chronic Pain From an Integrative Perspective

Room: Elgin

S46: How to Build Research Skills With CERA—Using National Educational Surveys for Faculty and Resident Scholarly Activity

Room: MacKenzie

S47: Taking It to the Streets: Innovative Strategies for Improving Care Engagement Among PWIDs Within Residency Practices

Room: Yorkville West

4–4:30 pm

Beverage Stations—Visit With Poster Presenters and Conference Partners

Room: Grand Ballroom Foyer and Osgoode Ballroom

Mindfulness Meditation Retreat

Room: Forest Hill

General Session

4:30–5:30 pm

Mālama Honua (Caring for Mother Earth): Lessons Learned About Health, Well-Being and the Future of Health Care



Marjorie Leimomi Mala Mau, MD

University of Hawai'i, John A. Burns School of Medicine

Whether you believe in climate change or not, one thing is clear, our global environment is changing. There is growing research on how environmental change influences human health as well as the health of animals, plants and the environment itself.

Dr Marjorie Mau is a professor and Myron “Pinky” Thompson endowed chair for Native Hawaiian Health Research at the John A. Burns School of Medicine at the University of Hawai'i. She is a board-certified endocrinologist and is the founding chair of the Department of Native Hawaiian Health, the first clinical department dedicated to indigenous health in a US-accredited medical school.

Room: Grand Ballroom

Tuesday, April 30



6:15 am

Annual STFM Foundation Marathonaki Fun Run/Walk (Sponsored by the College of Family Physicians Canada)

Room: Grand Ballroom Foyer (STFM Registration Desk)

7 am–5 pm

Conference Registration and Computer Café

Room: Grand Ballroom Foyer

7:15–8:15 am

Healthy Start Breakfast (Eggs, Muffins, Fruit, Yogurt, Oatmeal, Cereal)

Scholarly Topic Roundtable Presentations (See pages 56-59.)

Room: Grand Ballroom

8:30–9 am

STFM Annual Business Meeting

Beat Steiner, MD, MPH, STFM president

Room: Grand Ballroom

General Session

9–10 am

Building a Path to Better



Joshua Tepper, MD, MPH, MBA

North York General Hospital, Toronto, Canada

Quality and quality improvement are increasingly common terms found in our clinical practice environment as well as within our research and teaching agendas. In many respects, the dawning of the age of quality and improvement science matches similarly transformative moments in medicine such as evidence based medicine and inter professional care. We will explore the current state of quality in primary care, the building of QI capacity within the discipline and critical success factors.

Dr Tepper is a family physician and the president and chief executive officer of North York General Hospital. Previously he was the president and CEO of Health Quality Ontario.

Room: Grand Ballroom

10–11 am

Beverage Stations; Poster Session III: Dedicated Time for Poster Presentations (See pages 76-83.)

“Teach & Transform” With STFM Products and Services—Fellowships, Research and Publications

Room: Osgoode Ballroom and Foyer

11:15 am–12:15 pm: Lecture-Discussions

L10B: Improving Emergency Department Utilization at an Academic Family Medicine Practice: A Longitudinal Project to Improve Patient Care and Resident Education

Room: Kent (This session will be presented from 11:45 am-12:15 pm)

L42A: Interconception Care at a Teaching Community Health Center: Improving Maternal Child Health Through Pediatric Well Visit Screening

L42B: How Do You Build a Breastfeeding Curriculum?

Room: Kenora

L43A: What You Need to Know About the New Core Competencies for the Prevention and Management of Obesity

L43B: How to Build A Financially Viable, Evidence-Based, Weight Management Program in a Patient-Centered Medical Home: From Guidelines to Practice

Room: Provincial North

L44B: To Optimize Oral Treatments and Health in the Young (TOOTHY): A UNC Faculty Development Fellowship QI Collaborative Project

L46B: “How Do I Help This Kid?” Integrating Family-Oriented Behavioral Pediatrics in Family Medicine Training by Empowering Residents to Use Simple Screening and Intervention Tools With Patients and Families

Room: Dufferin

L45A: Utilizing the Single Accreditation System to Advance Osteopathic Training

L45B: Sports Medicine Specialty Track

Room: Huron

L47A: Meeting the Needs of Future Family Physicians: Teaching Payment Models in an Academic Family Medicine Residency

L47B: Alternative Models of Care: A New Curriculum Introducing Residents to Nontraditional Models of Primary Care

Room: Sheraton Hall C

L48A: Giving Your Procedure Clinic a Face-Lift

L48B: MSK Arts and Crafts: Teaching Procedural Skills in a Limited Resource Setting

Room: Simcoe

11:15 am–12:15 pm: Completed Research Projects

SESSION I: STFM Research Committee

CR11: Quality Improvement Tadpole Tank: Presented by the STFM Research Committee

Room: Sheraton Hall A

SESSION J: Health Services

CRJ1: Opportunities for Increased Specificity in Diagnosing Dementia: Georgia's Experience With the Medicare Fee-for-Service Population

CRJ2: Impact of Advanced Primary Care on Accountable Care Organizations

CRJ3: Predicting Emergency Department Utilization in a Population of Kaiser Permanente Napa-Solano Medi-Cal Patients

CRJ4: Associations Between Burnout and Practice Organization in Family Physicians

Room: Sheraton Hall B

11:15 am–12:15 pm: Completed Scholarly Projects

SESSION G

CSG1: Results From Implementing a Novel Clinical Decision Support Tool for the Management of Diabetes in a Family Medicine Residency

CSG2: A Comprehensive Electronic Template Serves as a Resident Teaching Tool and Improves Patient Outcomes in Prenatal Care

CSG3: Impact of Pharmacist-Physician Collaboration on Osteoporosis Treatment Rates

CSG4: Expanding the Team: Community Health Outreach Workers and Colorectal Cancer Screening

Room: Provincial South

11:15 am–12:15 pm: Panel Discussion

PD5: Is 0.8 the New 1.0? Part-Time Faculty Positions in Family Medicine

Room: City Hall

11:15 am–12:15 pm: Seminars

S06: Systems Behavior as Core Curriculum: Making an Integrated Residency Practice Thrive

Room: Yorkville West

S48: Medical Cannabinoids Prescribing Guideline: Sorting “Doobie”-ous Claims With “High”-Level Evidence (STFM-CFPC)

Room: Civic Ballroom North

S49: Presentation Skills Revamped: How to Take Your Presentation to the Next Level

Room: Wentworth

S51: Making Sense of Resident Wellness Curricula: A Delphi Study of Content Experts

Room: Elgin

S52: Small Pieces Make the Big Picture: Designing a Community Resource Fair Using the Jigsaw Method

Room: Davenport

S53: Mentorship for the Underrepresented in Leadership in Academic Medicine

Room: Civic Ballroom South

S54: Restructuring Our Approach to Maternal Substance Use: Leveraging Learners to Address Health Equity in Institutional Policy

Room: Leaside

S55: Recognizing Our Hidden Faculty: Integrating and Supporting the Role of Health Professional Educators in Family Medicine

Room: Dominion North

S56: Breaking the Silence: Dismantling Racism in Graduate Medical Education

Room: Dominion South

S57: Innovative Multidisciplinary Response to Victims of Human Trafficking: Family Medicine Residents are the Future!

Room: Churchill

S69: Updates in Miscarriage Management: Implications for Clinical Practice and Patient Care

Room: Forest Hill

12:15–1:45 pm

Lunch on Own

12:30–1:15 pm

Zen Yoga (Lunch is not provided.)

Room: Danforth

12:30–1:30 pm

Optional STFM Collaborative Meetings (See meetings list on page 87.)

1:45–2:45 pm: Lecture-Discussions

L28A: How Patients Identifiers Are Used in Medical School Curricula: Minimizing Bias and Stigma

L28B: Toward a Model for Critical Race Theory-Informed Care

Room: Dominion South

L49A: Immediate Postpartum LARC Insertion: Breaking Barriers to Reproductive Health Access

L49B: Using Curricular Management Structures for the Creation of a Longitudinal, Integrated Curriculum in Sexual Health

Room: Elgin

L50A: Strengths and Paradoxes in Medical Leadership Education: Can Postgraduate Programs Meet Contemporary Leadership and Clinical Demands Across Health Systems?

L50B: Expanding the Roles of Chief Residents in a Growing Residency

Room: Dufferin

L51A: Pretending: Establishing and Evaluating a Curriculum for R3 Preceptors in Clinic

L51B: Teaching Residents to Teach

Room: Huron

L52A: The 4-Year Residency in Family Medicine: Outcomes From the Nation's Fully Developed Programs

L52B: Clinic First: Innovations in Residency Training to Meet the Quadruple Aim

Room: Simcoe

L53A: The Black Bag: Creating a Platform to Collaborate in the Development of Video Curriculum

L53B: Implementing and Improving Simulation-Based Rapid Response Training Curriculum for Residents

Room: Wentworth

1:45–2:45 pm: Lecture-Discussions cont.

L54A: What's in an Hour? One Program's Experience in Meeting Accreditation Requirements by Counting Hours in an Innovative Miniblock Model

L54B: The Annual Program Review: A Strategy to Change a Program's Culture

Room: Dominion North

1:45–2:45 pm: Completed Research Projects

SESSION K: Residency

CRK1: Finding a Job With Obstetrics: New Family Physician Experiences

CRK2: How Much Do Family Medicine Residency Programs Spend on Resident Recruitment? A CERA Study

CRK3: Assessing the Acceptance of PrEP and Need for Teaching It Among Family Medicine Residency Programs

CRK4: The Sixth Vital Sign: Reconnecting With Our Patients as a Means to Improve Resident and Patient Experiences

Room: Sheraton Hall A

1:45–2:45 pm: Completed Scholarly Projects

SESSION H

CSH1: Identifying Patient-Reported Barriers to Care Amongst Frequently Hospitalized Family Medicine Patients

CSH2: Uncontrolled Diabetes in the Underserved: Lessons Learned From a Patient Compliance and SDOH Focused Interdisciplinary Pathway

CSH3: Protecting Sex Trafficked Victims: On Streets and in Clinics

CSH4: Impacting the Quality and Rates of Colorectal Screening in a Safety Net Population

Room: Sheraton Hall B

1:45–2:45 pm: Panel Discussion

PD6: Supporting Rural Family Teachers Using a Social Accountability Approach

Room: Kenora

1:45–2:45 pm: Seminars

S58: Combating the Opioid Crisis: A Battle Plan for Family Medicine Educators

Room: Civic Ballroom South

S59: Diabetes Group Visits: Implementation and Outcomes in a Family Medicine Residency—5 Years and Counting

Room: Kent

S60: Forensic Evaluations for Asylum Seekers: A Skill for Physicians to Advocate for Human Rights

Room: Civic Ballroom North

S61: WHY Active Learning Works (When it Does): Research, Evidence, and Examples

Room: Sheraton Hall C

S62: Didactic Sessions Promoting Wellness, Resiliency and Career Sustainability

Room: Churchill

S63: Implementing Competency-Based Assessment to Meet Accreditation Guidelines: Examples From Canadian Family Medicine Residency Training

Room: City Hall

S64: On the Bright Side: Building a Longitudinal Wellness Curriculum for Family Medicine Residents and Faculty in an Urban Underserved Community

Room: Davenport

S65: It's Just a Doctor's Appointment: An Innovative Curriculum to Teaching Behavioral Health in an Integrated Care Model

Room: Provincial North

S66: Developing and Implementing Curricula on Climate Change in Family Medicine Training (STFM-CFPC)

Room: Yorkville West

S67: Charting Statistics That Matter: Harnessing Intrinsic Motivation to Create Winning Leaderboards

Room: Leaside

S68: Assessment Across Boundaries (STFM-CFPC)

Room: Provincial South

2:45–3:30 pm

Beverage Stations—Final Opportunity to Visit With Conference Partners and Poster Presenters

Room: Grand Ballroom Foyer and Osgoode Ballroom

3:30–4:30 pm: Lecture-Discussions

L36A: Using Comparative Analysis to Refine an Interprofessional Educational Program and Curriculum

L36B: Combating Health Care Silos: How Medical Students Want to Learn the Provision of Interprofessional Care

Room: Kenora

L57A: From Anecdotes to Systems-Based Changes: Redesigning the Morbidity and Mortality Conference

L57B: Cognitive Bias in Medical Decision Making—Teaching Utilizing a Morbidity and Mortality Format

Room: Davenport

L58A: Get Rid of the Exams! Redesigning the Clinical Years of Medical School

L58B: Put Me in Coach! Benefits of Medical Student Coaching for Students, Faculty, and the Field of Family Medicine

Room: Dufferin

L59B: How to REALLY Take Time Off From Work

L59A: Parallelism in Faculty and Resident Development: How Well-Being is Becoming a PERMAH-nent Pillar in the Curriculum

Room: Civic Ballroom South

L60A: Understanding and Dealing With Burnout Across the Clinical and Academic Spectrum

L60B: You Cannot Meditate Your Way to Wellness: Organizational Strategies to Promote a Well Workforce

Room: Dominion North

L61A: Fixing the Leaky Pipe: Creating an Innovative Pipeline Program to Increase Underrepresented Minorities in the Health Professions

L61B: Changing the Narrative: A Multifaceted Approach to Integrating Inclusion, Diversity, Equity, and Allyship (IDEA) Principles Into Our Residency Program

Room: Civic Ballroom North

3:30–4:30 pm: Completed Research Projects

SESSION L: Health Disparities

CRL1: Metformin Associated With Lower Risk of Dementia in African-American Compared to White Patients With Diabetes

CRL2: FDA Certification of Treatments for Infection With Hepatitis C Virus and Increased Racial Disparities in Mortality From Hepatocellular Carcinoma

CRL3: Assessing Barriers to Participation at a Clinic-Based Medical Food Pantry in Food Insecure Patients With Chronic Disease

CRL4: Persistent Racial Inequalities in Mortality From HIV After Introduction of Highly-Active Antiretroviral Treatment (HAART)

Room: Sheraton Hall A

3:30–4:30 pm: Completed Scholarly Projects

SESSION I

CSI1: Sexual Harassment and Gender Discrimination in Family Medicine Education: A Qualitative Approach

CSI2: Rekindling the Joy in Practice, Reducing Burnout, and Improving Physician Satisfaction

CSI3: From Classroom to Clinic: A Novel Integrated Curriculum to Teach Ethical Decision Making to Family Medicine Residents

CSI4: Wellness Practice Improvement: Using Quality Improvement Tools to Affect the Well-Being of Family Physicians and Their Trainees

Room: Sheraton Hall B

3:30–4:30 pm: Seminars

S70: Interprofessional Education and Care in Residency Teaching Practices: Approaches From Five Bright Spots

Room: Provincial South

S71: Beyond Recruitment: Retaining and Supporting Physicians of Color

Room: City Hall

S72: Integrating Patient Safety Into Clinic Teaching Using Incident Analysis

Room: Huron

3:30–4:30 pm: Seminars cont.

S73: Using a Case-Based Curriculum to Train Faculty in Medication Abortion

Room: Elgin

S74: US Work on Diversity and Allyship and Canadian Pursuit of Cultural Competence, Safety, and Humility (STFM-CFPC)

Room: Churchill

3:30–4:30 pm: Workshops

W07: Escaping the Average Teaching Technique: First Solve and Then Build an Escape Room!

Room: Kent

W09: Speed Group Mentoring for Women Physicians

Room: Provincial North

W10: Pursuing Scholarship: Creating Effective Conference Submissions

Room: Sheraton Hall C

W11: FamPop 2019—Moving From the Clinic to the Community: How to Build a Community Program That Teaches Population and Public Health Skills

Room: Simcoe

W12: Getting Ready to Leap: Preparing Midcareer Faculty to Take the Next Career Step

Room: Dominion South

W13: Developing Your Philosophy of Teaching: Why Does It Matter?

Room: Wentworth

8–9 pm

STFM Movie Night—“No Mas Bebés”

Room: City Hall

9 pm–Midnight

Annual Spring Conference Dance Party

Room: Dominion Ballroom

Wednesday, May 1



7–11 am

Conference Registration

Room: Grand Ballroom Foyer

7:30–8 am

Healthy Start Breakfast (Muffins, Yogurt)

Room: Grand Ballroom

8–9:30 am: Workshops

W14: Choose Your Own Adventure for HOT Topics in Addiction and Chronic Pain: Pick 3 of 10 Learning Stations to Delve Deeper Into! (Supported by NIDA)

Room: Provincial South

W15: Thriving in Practice: Cultivating Compassion in the Clinic

Room: MacKenzie

W16: Approaching Faculty Retirement: Not an Event, but a Process With Gains and Losses

Room: Dufferin

W17: Making It Count: Tips and Tricks for Creating an Educator Portfolio

Room: Huron

W19: In Uncertain Terms: Using Small Group Learning to Teach Residents How to Effectively Engage Clinical Uncertainty

Room: Rosedale

8:30–9:30 am: Lecture-Discussions

L62A: Assessing Residents and Rotations: An Exercise in Program Improvement and Automation

L62B: The Carrot and the Stick—How to Get a (Near) 100% Completion Rate for Evaluations and Other Paperwork

Room: Leaside

L63A: Evaluating Racial Bias in the Residency Application Review Process

L63B: Utilizing a Rubric in ERAS to Enhance Diversity in Resident Recruitment

Room: Wentworth

L64A: Parental Leave in Residency: Creating a Formal Parental Leave Policy

L64B: Tools to Meet ACGME Requirements to Monitor Resident Well-Being: A Review of the Options

Room: Forest Hill

L65A: Faculty Development via Distance Learning for a New Rural Residency

L65B: Teaching Community Medicine to Achieve Competence and Retention for Rural Practice

Room: Kent

L66A: Microresearch: Promoting Scholarly Activity in Rural Programs

L66B: A Design and Dissemination Studio: Building a Community of Practice in Rural Health Professions Education and Training

Room: Roosevelt

8:30–9:30 am: Completed Research Projects

SESSION M: Education

CRM1: Use of Race and Ethnicity on the American Board of Family Medicine In-Training Examination

CRM2: Midwives as Educators of Family Medicine Residents: Harmony and Disharmony in the Results of Surveys of Certified Nurse Midwives and Residency Program Directors

CRM3: A Call for Interprofessional Geriatrics Education: Strengthening the Choir

CRM4: Use of the Jefferson Teamwork Observation Guide (JTOG) in a Family Medicine Clerkship

Room: Civic Ballroom North

SESSION N: Clinical

CRN1: Effects of Scribes on Physician Usage of the Electronic Health Record: Perception vs Reality

CRN2: Health-Related Internet Use in Community Health Settings: Insights From Patient and Provider Perspectives

CRN3: Essential Office Procedures for Medicare Patients

CRN4: Characteristics and Demographics of Family Physicians Who Deliver Babies and Prescribe Buprenorphine

Room: Civic Ballroom South

8:30–9:30 am: Seminars

S07: Behavioral Science Curriculum Development: From Principles to Practice

Room: Danforth

S11: Welcome to the Family: Promoting Interest in Family Medicine (STFM-CFPC)

Room: Churchill

S76: Food is Health: Reducing Food Insecurity Among Diabetic Patients and Engaging Residents in Health Equity Initiative

Room: Kensington

S79: The Formula for Building an Effective Simulation

Room: Cedar

S80: Case Report Workshop

Room: Kenora

S81: Engaged Teaching for the Busy Clinician—Letting Go of “The Lecture”

Room: Simcoe

S82: How to Succeed as a Medical Educator

Room: Provincial North

S84: Preparing Residents to Provide Abortion in Family Medicine After Residency Graduation

Room: Yorkville West

9:45–10 am

STFM Presidential Recognition and Passing of the Gavel

*Beat Steiner, MD, MPH, STFM president and
Frederick Chen, MD, MPH, STFM president-elect*

Room: Grand Ballroom

Closing General Session

10–11 am

The Health Equity Imperative: Building a Family Medicine Workforce Prepared to Deliver Socially Informed Care



America Bracho, MD, MPH

Latino Health Access, Santa Ana, CA

In this presentation, Dr America Bracho will discuss the connection between social determinants and health and the increasing roles of Community Health Workers in improving community health with additional focus on equity, inter-sectorial collaboration and community engagement.

Dr America Bracho is the executive director of Latino Health Access, a center for health promotion and disease prevention located in Santa Ana, California and is a co-author of the recently published book “Recruiting the heart and training the brain: the work of Latino Health Access.” She has been featured in several documentaries including the HBO Special “The Weight of the Nation” and a TedMed Talk on the role of patients in improving health care and their communities.

Room: Grand Ballroom

Dr Bracho will be signing her books immediately following her presentation in the Grand Ballroom Foyer.

11 am

Conference Adjourns

Scholarly Topic Roundtable Discussions



Sunday, April 28: 7:15–8:15 am

Room: Grand Ballroom

B001: Reproductive Justice: What's It About? Open Book Club Discussion

B002: Peer Support: Clinicians Supporting Clinicians Through Adverse Patient Outcomes

B003: Updated Entrustable Professional Activities for a Canadian Family Medicine Residency Training Program

B004: Setting Up a Psychiatry and Behavioral Fellowship in a Family Medicine Residency

B005: Practice Makes Perfect: Training Family Residents in Difficult Patient Encounters

B006: Creating a Community of Clinician Educators Through Longitudinal Faculty Development

B007: Mobile Clinic as Vehicle for Community Health Curriculum

B008: Model for Improving LGBTQ Health Training in a Midwestern Family Medicine Residency

B009: Development of an Immigrant Medicine Elective for Preclinical Medical Students

B010: Suffering, Burnout, and Moral Injuries: What's the Good News?

B011: Growing Your Own—Rural Family Physicians

B012: How to Implement a Resident-Driven Values-Based Interview Process

B013: Community Organizing Curriculum in Residency

B014: Resident Patient Safety Clinical Learning Environment Curriculum

B016: Envisioning Social Justice in Residency: Successes and Challenges of a Work Group to Promote Diversity, Equity, and Inclusion

B017: What's for Dinner: Ensuring Wellness Is on the Menu in Accelerated Medical School Curricula

B018: Implementing a Spanish Language Curriculum at a Northern Manhattan Residency Program

B019: Won't You Be My Neighborly Physician? Lessons for Family Physicians From Mr Rogers

B020: Rural Full-Spectrum Family Medicine Resident and Student Rotations With IHS: Inspiration and Burnout Prevention

Sunday, April 28: 7:15–8:15 am cont.

Room: Grand Ballroom

B021: Developing a Family Medicine Point-of-Care Ultrasound Curriculum in a Large Multidisciplinary Academic Environment: Successes, Challenges, and Lessons Learned

B022: This Is Getting Old: Bringing New Life Into a Geriatric Curriculum in a Family Medicine Residency

B023: Innovative Solutions to Support Medication-Assisted Treatment for Opioid Use Disorder in a Rural Training Track

B024: Team-Based Implementation of a Diabetes Prevention Program at a Family Medicine Residency

B025: Embedding Health Equity Training Opportunities in a Community-Based Family Medicine Residency

B026: The Opioid Prescription Tool to Address Optimal Utilization of Treatment (OPT-OUT) Initiative: Interprofessional Collaborations for Engaging Community Pharmacies in Patient Education on Safe Opioid Practices

B027: “COME”ing Home to Community-Oriented Medical Education: Student Reflections on Community Selectives in FM Clerkship Experiences

B028: Medical Checklists

B029: The Role of the Family Physician in Precision Medicine

B030: Addressing the Mental Health Gap: Creating a Family Medicine and Psychiatry Collaborative Care Model

B031: Investigation Into the Inadequate Capturing of Medical Marijuana Use in EMRs by Providers in the Primary Care Setting

B033: Addressing Obesity: Review of Provider Core Competencies

B034: USF-MPM Family Medicine Residency Geriatrics Workforce Enhancement Program

B035: Residency Scholarly Activities: Fulfilling ACGME Requirements and Milestones

B036: You Get What You Give: Implementing Resident-Faculty Feedback Loops

B037: Help! How Do I Learn to Teach in Academic Medicine? Educational Resources and Where to Find Them for New Faculty Members

- B039:** Setting Residents up for Success: Development of a Comprehensive Board Preparatory Curriculum
- B040:** Bringing Hepatitis C Treatment and Management Into Family Medicine Residency Clinics
- B041:** Osteopathic Recognition Track: A Sharing of Ideas and Best Practices
- B042:** Update on the Faculty Competencies Project
- B043:** Faculty Development for Midcareer Residency Faculty: A Needs Analysis
- B044:** There's an App for That! How to Design and Implement a Smartphone Application in a Family Medicine Residency
- B045:** Advising Advisors: A Dynamic Guide to Advisor Roles and Responsibilities in Family Medicine Residency
- B046:** How Deep Is Your Well? A Behavioral Science Consortium's Guide to Enhancing Wellness for Ourselves and Our Programs
- B047:** Promoting Clinical Efficiency Through Narrative Medicine
- B048:** Professionalism Skill Training for the Millennial Generation
- B049:** Breaking Down Barriers to Implement a Buprenorphine Clinic in the Residency Setting
- B050:** Improving Feedback From Family Medicine Clerkship Preceptors
- B051:** A QI Project: Improving Our Quality Curriculum
- B052:** Equity and Diversity in Family Medicine Leadership—Revisiting the 2018 Preconference and Determining Next Steps
- B053:** Food for Thought: Integrating Nutrition Education Into Residency Curriculum
- B054:** Time in the Cloud: Use of an Online Forum to Stimulate Reflection on Social Determinants and Community Health
- B056:** Maternal Health Access Project
- B057:** Behavioral Health Faculty Shadowing Residents: Evaluation Form That Maps to the Milestones
- B058:** Cultivating Professionalism and Communication Skills Through Balint Groups
- B060:** Group Visits/Shared Medical Appointments—From Special Project Team to STFM Collaborative

Sunday, April 28: 7:15–8:15 am cont.

Room: Grand Ballroom

B061: Does Empaneling Patients Improve the Clinic Experience for Residents and Their Patients?

B088: Towards Justice-Doing in Family Medicine: A Conversation on Teaching and Applying Structural Competency

B089: Hospital to Home: Teaching Best Practices and Preferences in Communication

B092: Suboxone Emergency: Bridging Suboxone Inductions From the ER to PCP

B104: Medical Scribes in a Family Medicine Residency Program: An Implementation Outcomes Study

B130: Comparing 2 Approaches to Help Students Integrate and Prepare for USMLE Step 2 CS

Tuesday, April 30: 7:15–8:15 am

Room: Grand Ballroom

B038: Improving Critical Care Scenario Training Using Rapid Cycle Deliberate Practice

B055: Hidden in Plain Sight: The Family Medicine Physician and Uncertainty Work

B059: Conscientious Objectors in Reproductive Medicine: When Residents and Faculty Do Not Treat

B062: Teaching Students, Residents, and Patients How to Approach Chronic Somatic Symptoms

B063: Preparing Future Family Physicians to Understand the Options for Opioid Use and Misuse

B064: Innovative National Consortium-Based Teaching Health Center Family Medicine Residency Program—Opportunities and Challenges From Recent Graduates

B065: My MDs Want to Learn Osteopathic Medicine...Can We Do That?

B066: Group Well-Child Visits in Family Medicine Residency Programs: What's the Best Approach?

B067: The Procedural Competency Evaluation Process: Consensus and Consistency

B068: Lifestyle Medicine: An Overview of the Field and How it Relates to Family Medicine

B069: Development of a Longitudinal Inpatient Curriculum

B070: Medical Record Documentation and Saturday School: Training Residents to Be Accurate and Timely

B071: Conversation With the Editors of *Family Medicine*

B072: Combatting Loneliness in Family Medicine Residents: Enhancing Wellness by Enhancing Connectiveness

B073: Developing a Curriculum and Interprofessional Care Model to Address the Opioid Epidemic

B074: Reproductive Health and Advocacy Training—How to Best Prepare our Residents

B075: An Integrated Residency to Retain Medical Students in Their Home Residency Program

B076: How to Start a Transgender Training Program in Your Residency Program

B077: Fostering Resident Interest in Maternity Care

B078: Supporting Community Preceptors Through Effective Onboarding at a Family Medicine Residency

B079: International Outreach

B080: Integrating MAT Into Family Medicine Residency Training

B081: Milestones: Does Perception Meet Performance?

B082: Dermoscopy: Opportunities and Resources for Learning, Teaching, and Research

B083: Integrating an LGBTQ+ Curriculum in Family Medicine Residency Training

B084: Combating the Opioid Crisis: A Battle Plan for FM Educators

B085: A Team-Based Interdisciplinary Approach to Creating and Sustaining a Family Medicine Residency Quality Improvement Curriculum

B086: Utilizing Technology to Engage the Millennial Learner

B087: Implementing Advance Care Planning Into a Teaching Health Center FQHC

B090: Virtual Reality Making Shots Virtually Painless: The Childhood Anxiety Reduction Through Innovation and Technology (CHARIOT) Program

Tuesday, April 30: 7:15–8:15 am cont.

Room: Grand Ballroom

B091: Pipeline Crisis: Tracking System for Monitoring Student Interest

B093: Medicine and the #MeToo Movement: Findings of a Literature Review on Sexual Harassment

B094: Leadership for Life

B095: Building a Community of Residents: A Discussion About a Unique Way to Get Your Residents Active in Their Community

B096: Learning Spanish in Residency—Si Tu Puedes

B097: Introducing MSK Ultrasound in a Family Medicine Clerkship: An Update With Student Reviews

B098: Nutrition Group Education—Pearls, Pitfalls, and a Potential Recruiting Tool for Family Medicine

B099: Primary Care Endoscopy Training in Rural Montana

B100: Growing Your Own: Developing Five Fellowships in a Community Family Medicine Residency

B101: How to Take a Gender History: Incorporating Gender in Annual Wellness Visits

B102: Apps and Websites for Medical Student, Resident, and Patient Education

B103: Demystifying the IRB Process for Family Medicine Investigators

B105: Ten Ways Artificial Intelligence Will Transform Primary Care: Implications for Medical Education

B108: Physician as Patient Elective: Honoring Personal Illness as a Teacher of Medicine

B109: Walking the Walk of Team-Based Care: Resident/MA Partnership With “Medical Assistants as Faculty”

B110: Teaching Mindful Self-Compassion on Inpatient Hospital Rounds and in the Clinic When Dealing With Stressful Situations

B111: Issues Faced by Senior Female Physicians

B113: Yes, We Will! Using a Patient Wellness Group to Engage Family Medicine Residents in Community Empowerment

B114: The Efficient Clinical Competency Committee (CCC): Innovative Tips for Getting the Work Done and Meeting Accreditation Requirements

B115: An App Can Do That: Point-of-Care Apps for FP's, Residents, and Students

B116: MacGyver Medicine: Teaching Adaptability and Creativity in Low-Resource Settings Through Case-Based Learning

B117: Crafting Resilience: Designing an Integrated, Experiential Wellness Curriculum for Your Residency

B118: GME at State and Federal Levels: "Connecting the Dots" on the Ground

B119: The Workings of Warm Hand-Offs and Ongoing Integrative Patient Care

B120: A Longitudinal, Developmental, Competency-Based Curriculum in Advanced Primary Care

B121: Combatting Disuse Atrophy in Family Medicine Education

B122: Supporting Family Medicine Teachers With Educational Leadership Tasks Inherent in Their Academic Roles

B123: Social Media Usage in Residency Education

B124: Developing a Program to Incorporate the Ideal Career Model to Help Fulfill Eight Dimensions of Wellness

B125: A New 2-Week Osteopathic Manipulative Medicine Rotation for Osteopaths and Allopaths

B126: A Roadmap to Improving Heart Health and Brain Health in Primary Care

B127: Recruitment and Support of Underrepresented Minority Physicians

B128: How to Develop and Establish a Practical Hands-On Based FM POCUS Curriculum and Training Program in a FM Residency Program

B129: Incorporating Minor Procedure Training Into Family Medicine Core Clerkship

B131: Addressing the "Efficiency Deficiency" in Resident Education: Constructing a Needs Assessment to Develop a Longitudinal Clinic Efficiency Curriculum

B132: Motherhood in Medicine: A Review of the Literature and Discussion of Case Studies

Poster Presentations



Sunday, April 28: 1:15–2:15 pm**Room: Osgoode Ballroom****Completed Research Posters**

RP01: Relationship Between Change in Posttraumatic Stress Disorder Symptoms and Body Mass Index in Veterans

RP02: Increasing Low-SES Consumers Access and Use of Milwaukee Farmers Markets to Improve Produce Intake

RP03: Screening for Health-Harming Legal Needs in Primary Care: Pilot Data to Inform a Medical-Legal Partnership Evaluation

RP04: MMR Vaccination Hesitancy in a Rural Somali Population in Nebraska

RP05: Exploring the Relationship Between Mood Disorders and Glycemic Control Among the Napa-Solano Adult Diabetic Patients

RP06: Implementing SBIRT: Impact on Medical Provider and Staff Perceptions and Competence

RP07: Screening for Risky Substance Use at Two Primary Care Clinics: What Happens When Patients Screen Positive?

RP08: Improving Pneumococcal Vaccination Rates in an Academic Clinical Setting

RP09: Utilizing Tools to Assess Fall Risk

RP10: Improving Breastfeeding Knowledge, Skill and Confidence Among Family Medicine Learners

RP11: Resident and Preceptor Attitudes About Providing Medical-Aid-in-Dying Under the California End-of-Life Options Act: Implications for Resident Training

RP12: Obstetric Care by Family Physicians and Infant Mortality in Rural Alabama

RP13: The Impact of Early Family Doctor Attachments on Medical Student Attitudes Towards Professionalism

RP39: Family Medicine Journal Club: To Tweet or Not to Tweet?

Sunday, April 28: 1:15–2:15 pm

Room: Osgoode Ballroom

Completed Scholarly Project Posters

CP01: Obesity Bias Education: Fourth-Year Medical Student Outcomes

CP02: Improving Continuity of Care in a Family Medicine Residency Program

CP03: Sustained Mitigation of Obesity Bias in a Family Medicine Residency Program

CP04: Using a Group Medical Visit Model to Promote Healthy Lifestyle Change With an Underserved Population

CP05: Interplay Between Culture, Work-to-Family Conflict, and Work Demands in Women in Primary Care

CP06: Perceived Barriers to Advance Care Planning in a Hospital Setting

CP07: Use of an Entrustability Scale to Inform Resident Continuity Clinic Performance

CP08: Developing a Population Health Elective for 4th-year Medical Students Interested in Primary Care

CP09: Emotional Exhaustion Within a Family Medicine Residency Program

CP10: Fruit and Veggie Prescription Program: Addressing Food Insecurity Through a Primary Care Clinic-Based Healthy Food Access Program

CP12: Cocreating Academic Manuscripts: The POP Plan

CP17: Innovations to Increase Didactics Attendance and Participation in a Family Medicine Residency Program

CP35: Evaluating the Effects of a Single Intervention on Implicit Bias in Family Medicine Residents and Faculty

Sunday, April 28: 1:15–2:15 pm

Room: Osgoode Ballroom

Developing Scholarly Project Posters

DP001: Using Resident Practice Sharing as a Strategy to Support Interpersonal Continuity in a Family Medicine Residency

DP002: Using a Resident-Led Passport Tool to Enhance Reflection During an Interdisciplinary Inner-City Family Medicine Rotation

DP003: Evaluation of Warfarin Management in a Family Medicine Residency Clinic

DP004: If You Build It: The Effects of the Establishment of a Procedure Clinic Within a Family Medicine Residency Practice Site

DP005: Narrative Medicine Rounds in the Family Medicine Clerkship: Using Storytelling to Facilitate Medical Student Well-Being

DP006: Assessing Capability of a Diverse Diabetic Population

DP007: Creating a Longitudinal Point-of-Care Ultrasound Curriculum Within a Large Academic Institution for Family Medicine Residents: A Multispecialty Approach

DP008: What Do You C in My LIC? Residents' Experiences With the Longitudinal Integrated Curriculum

DP009: Development of a Pilot Podcast for Health Professions Learners

DP010: A Randomized Controlled Trial of Health Coaching and Education for Diabetes Distress (CEDD Trial)

DP011: Impact of an Interprofessional Nutrition Rotation

DP012: Implementation of Training and Skills Competency Assessment for Medical Assistants in Family Practice Clinics

DP013: Evaluating Efficacy of a Standardized and Integrated LGBTQ Health Care Curriculum and Family Medicine Residency Training

DP014: Improving Resident-to-Resident Communication in the Inpatient Setting

DP015: Boston University Resident Scholarship Curriculum: An Evidence-Based Redesign of Resident Scholarly Activity

DP016: Formative Assessment of Clinical Reasoning Using Key-Feature Questions in the Family Medicine Clerkship

DP017: Development of Experiential Learning Exercises About Social Determinants of Health

DP018: Patient Preferences and Contraception Consistency in Self-Identified Latina Women in Baltimore

DP019: A Competency-Based Curriculum for Integrated Behavioral Health: Results From a Pilot Study

Sunday, April 28: 1:15–2:15 pm

Room: Osgoode Ballroom

Developing Scholarly Project Posters cont.

DP020: A Demonstration of Interprofessional Collaboration Between Family Medicine and Dental Providers Regarding Oral Health Risk Assessment

DP021: Teaching Human Trafficking Curriculum in Undergraduate Medical Education

DP022: Reconceptualization of a Wellness Curriculum Through Peer Mentorship in a Family Medicine Residency Program

DP023: Assembling the Blocks of a Continuous Quality Improvement Curriculum in an Innovative Miniblock Model

DP024: Filling a Gap in Performing POCUS: Developing a Workflow to Standardize Quality in a Family Medicine Outpatient Clinic in Japan

DP025: Developing a Multidisciplinary Post-Hospital Discharge Continuity Clinic in a Family Medicine Residency

DP026: Advancing Genomics Education in Family Medicine Residency Training

DP027: Introducing Pecha Kucha to Family Medicine Resident Didactics Sessions: Say What You Mean, Mean What You Say, Then Sit Down

DP028: Docs on Bikes: An Innovative Educational Program on Social Determinants of Health and Health Care Disparities

DP029: Using Formal Program Planning and Evaluation Methods to Create a New Program to Help Diabetic Patients Self-Manage

DP030: Using the College of Family Physicians of Canada's Key Features as Core Competencies for Family Medicine Entrustable Professional Activities: A Mapping and Validation Project

DP031: Use of a Daily Prompt System to Encourage Feedback

DP032: Development of a “High Fidelity Patient” Simulation Curriculum in a Community-Based Residency

DP033: Developing a Curriculum to Enrich Exposure to Gastroenterology and Colonoscopy for the Family Medicine Resident

DP034: Improved Control of Type 2 Diabetes Mellitus in a Primary Care Population Using Point-of-Care HbA1C Testing

DP035: Making Epidemiology Relevant Through Interdisciplinary Case-Based Teaching

DP036: Anatomy of a Pharmacotherapy Elective

DP037: Portability of Curricular Changes to Increase Resident Scholarly Activity

DP038: Stethoscopes and Sippy Cups

DP107: Reducing Resident Distress: Implementation of a Longitudinal Well-Being Curriculum in an Urban Academic Family Medicine Program

Sunday, April 28: 1:15–2:15 pm

Room: Osgoode Ballroom

Fellows, Residents, or Students Research Works-in-Progress Posters

FP01: Addressing the Opiate Crisis: Community Partnerships With Primary Care Providers in Southern New Mexico

FP02: Understanding the Culture That Contributes to Resident and Fellow Burnout: Preliminary Report on an Institution-Wide Survey

FP03: Diabetes Group Visits in a Residency Clinic: Training Residents to Facilitate Patient Empowerment

FP04: Studying Technology Acceptance to Improve Advanced Usage of Patient Portals

FP05: Assessing Abortion Patients' Access to Contraception and Attitudes Towards Contraceptive Counseling

FP06: REFRAME-TOC: Pharmacists Enhancing Follow up, Reducing and Assisting With Medication Errors During Transitions of Care

FP07: The Underdiagnosis of Pediatric Overweight and Obesity in a Resident Teaching Clinic

FP08: Perceptions of Rural Physician Retention by Long-Standing and Recently Recruited Physicians

FP09: Perceptions of Research by Schulich School of Medicine and Dentistry Physicians Located in Distributed Sites

FP10: Trends in Colon Cancer Screening With Fecal Immunoassay Testing

FP11: Instituting a Vaccine Refusal Form to Decrease Vaccine Deviation Rates in a Family Medicine Practice

Sunday, April 28: 1:15–2:15 pm

Room: Osgoode Ballroom

Fellows, Residents, or Students Research Works-in-Progress Posters cont.

FP12: No Strings Attached: Addressing Unintended Pregnancy in NC With Immediate Postpartum Contraception Training in Residency

FP13: An Hour of Prevention is Worth a Pound of Cure: Stopping Disease Progression in Prediabetic Patients Through Education

FP14: Statin Therapy Assessment and Team-Based Integrative Partnership (STATIN)

FP15: Exploring Human Papillomavirus Vaccination Rates of Patients in Family Medicine Clinic Sites in the West Side of Chicago

FP16: The Association Between Working in a Medically Underserved Community and Physician Well-Being

FP17: Postdischarge Primary Care Follow-ups: A Key to Reducing Hospital Readmissions?

FP18: Cardiovascular Screening in Breast Cancer Survivors: A Retrospective Case-Control Study

FP19: Impact of Prenatal and Postpartum Contraceptive Counseling on Postpartum Contraceptive Use and Subsequent IPI

FP20: Prior Depression Associated With Current Pregnancy Depression Diagnosis

FP22: Comparing the Prevalence of Adolescent Athletes With Elevated BPs on Preparticipation Physicals and Their Physician Recs

FP23: Identifying and Addressing Barriers to HPV Vaccination Initiation and Completion in a Primary Care Setting

FP24: Point-of-Care Ultrasound Curriculum Proposal for Family Medicine Residents

FP25: Chlamydia Infection is Not Increased Among Adolescent Long-Acting Reversible Contraceptive (LARC) Users

FP26: Impact of Telephonic Medication Management Services During Transitions of Care in a Family Medicine Teaching Clinic

FP27: Evaluation of a Universal Alcohol Use Screening Initiative

FP28: Assessing Reasons for Long-Acting Reversible Contraceptive Discontinuation in a Residency Family Planning Clinic

FP29: Comparing Outcomes of Neonates Born to Mothers With Opioid Use Disorder

FP30: A Strategy to Improve Broad Spectrum Antibiotic Overuse at a Community-Teaching Hospital

FP31: Improving Health Maintenance at a Primary Care Clinic

FP32: Youths' Perceptions of Nutritional Information on Menus: A National Mixed-Method Survey

FP33: Improving Pediatric Vaccination Rates in a Family Medicine Residency Clinic

FP34: Data-Driven Community-Based Care for Patients With Complex Health and Social Needs

FP35: Health Behavior Outcomes of Patients Utilizing the Fresh Produce Program

FP36: Innovative Solutions to Support Medication Assisted Treatment of Opioid Use Disorder in a Rural Residency Clinic

FP37: Improving Musculoskeletal Education in Primary Care Residency Programs

FP38: Barriers and Facilitators to Family Planning Access in a Family Medicine Resident Clinic

FP39: A Multicomponent Quality Improvement Project to Improve Sleep in Hospitalized Patients: A Single Center Pilot Experience

FP40: Impact of Education and Communication on Pain Reassessment in the Emergency Department

FP41: Resident vs Patients' Perceptions of Encounters, Using Patient Feedback to Guide Resident Education: Work in Progress

FP42: Innovating an Evidence Informed Decision-Making Curriculum: A Nonrandomized Cluster Controlled Trial

FP43: Implementing and Evaluating a Longitudinal LGBTQ Healthcare Curriculum at UC Davis Family and Community Medicine Residency

FP44: Racial and Ethnic Differences in the Prevalence of the Drug-Seeking Behavior

FP45: Evidence for Equity: Training Residents to Implement Evidence-Informed Interventions to Address Social Determinants of Health

FP46: Safety and Efficacy of Direct Oral Anticoagulants in Extreme Body Weights

Sunday, April 28: 1:15–2:15 pm

Room: Osgoode Ballroom

Fellows, Residents, or Students Research Works-in-Progress Posters cont.

FP47: Perspectives of Primary Care Providers (PCPs) on Outside-Office-Communication With Patients

FP48: The Effect of EMR Templates on Medicare Annual Wellness Visit Utilization

FP49: Grounding Frequent Flyers: Bringing the PCMH Model to the Group Home Setting

FP50: Factors Associated With Decision to Admit Among Low Risk Patients With Community-Acquired Pneumonia (CAP)

FP51: Tackling Obesity From the Ground Up: A Quality Improvement Project to Improve Obesity Management and Identification

FP68: Eat, Play, Learn

Monday, April 29: 10–11 am

Room: Osgoode Ballroom

Completed Research Posters

RP14: Examining Media Discussions of K-12 Sex Education in the 2015 Ontario Health and Physical Education Curriculum: Towards Collaborative Sexual Health Promotion

RP15: A Retrospective Chart Review: Long-Acting Reversible Contraception Utilization at University Medical Center

RP16: Patient Perception of Medical Education During Clinical Consultation at a Family Medicine Residency

RP17: Exploring University of Toronto PGY-2 Family Medicine Resident Socialization Process in Horizontal and Block Style Curriculums Through Key Informant Interviews

RP18: Implementation of a Long-Acting Reversible Contraception Program on a Mobile Health Center in Miami Dade County, Florida: A Pilot Quality Improvement Analysis

RP19: Water Justice in Watts: A Residency Community Partnership to Address Environmental Racism

RP20: Arabic-Speaking Refugee Women's Health Disparities Initiative

RP22: Reasons Patients Report Missing Appointments in an Urban Community Family Practice Clinic

RP23: Mood and Anxiety ECHO: An Innovative Approach to Building Primary Care Providers' Capacities to Manage Common Behavioral Health Conditions

RP24: A Team-Based Resident-Led Program to Achieve Quality Measures in a Family Medicine Clinic

RP25: Screening for Depression: A Comprehensive QI Project in the Family Medicine Department

RP26: The Doctor-Patient Relationship: What Physician Qualities Improve Trust Amongst Women Reentering the Community After Incarceration?

RP40: CERA Best Research Paper: Institutional NIH Research Funding and a Culture of Support for Family Medicine—Their Relationship to Family Medicine Specialty Choice

Monday, April 29: 10–11 am

Room: Osgoode Ballroom

Completed Scholarly Project Posters

CP13: Multidisciplinary Strategy for Improving Geriatrics Curriculum

CP14: Pilot of Triple P (Positive Parenting Program) in a Residency Clinic

CP15: The Role of a Department of Family and Community Medicine in Providing Advanced Faculty Development to a Wide Community of Health Professions Faculty

CP16: Online Shared Residency Education Materials: OB Readings

CP18: Improving Procedures Training in an Academic Family Medicine Residency Program

CP19: Increasing the Number of Pediatric Patients in an Academic Family Medical Center

CP20: Safe Communication With Limited-English Proficiency Patients: Language Proficiency Testing for Medical Providers

CP22: Call the Midwife? 15 Years of Interprofessional Obstetrics Practice at Tallahassee Memorial HealthCare Family Medicine Residency Program

CP23: Protecting Sex Trafficked Victims: On Streets and in Clinics

Monday, April 29: 10–11 am

Room: Osgoode Ballroom

Developing Scholarly Project Posters

DP039: Assessing Hypertension and Diabetes Treatment Intensification Decisions as Part of a Medical Student Quality Improvement Curriculum

DP040: Promoting Self-Directed Learning in a Residency Didactic Curriculum

DP041: Improving Interrater Reliability of OSCEs in a Family Medicine Residency

DP042: Referrals: The Conundrum of Reducing Referrals While Improving Patient Care

DP043: .Colonoscopy: How a SmartPhrase Led to the Integration of Technology in Undergraduate Medical Education to Improve Patient Care

DP044: Pay to Pass? Do Family Medicine Residency Programs With Dedicated Curricula and Subsidized Materials Have Lower Rates of First-Time ABFM Certification Exam Failure?

DP045: Resident Education Through Participation in a Diabetes Clinic

DP046: Addressing Resident and Faculty Burnout in a Family Medicine Residency Clinic: Comparing a Scribe Model With the Traditional Care Model in the Training Environment

DP047: Creation of a Longitudinal Resident Leadership Program and Outcomes From Years One and Two

DP048: Implementation of Team Care Training and Team Care Practice

DP049: Evaluation of a New Refugee/Asylee Health Elective for Family Medicine Residents

DP050: Assessing a Longitudinal Geriatrics Curriculum

DP051: A Scoping Review of Medical School Practices to Support Primary Care Specialty Choice

DP052: Using a Novel, Theory-Based, Ultrabrief Feedback Form to Improve Precepting

DP053: Quality Improvement and Patient Safety Conference: Enhancing Patient Safety Curriculum With an Alternative to Morbidity and Mortality Conference

DP054: OB-Newborn TEACH Cards: An Innovative Curricular Tool for Inpatient Maternal-Child Rotations

DP056: Development of a Refugee Health Curriculum—Perspectives of Refugees and Providers

DP057: Independent Learning Curriculum With Video Capture of Suturing Skills for Family Medicine Residents

DP058: Influences on Family Medicine Physicians' Scope of Practice

DP059: Development of Online Curriculum for Family Maternity Care Rotation

DP060: This Rural Mission—Using a Podcast Series to Introduce Information About Rural Health Disparities to Premedical Students

DP061: Family Medicine Clerkship Student Led Waiting Room Exercise Module Improves Wait Time Satisfaction

DP062: Does a Simple Before-and-After Educational Survey Promote Selection of Primary Care as a Career Choice Among the Premedical Community?

DP063: Incorporating Newer Antidiabetic Oral Medications Into Practice at a Federally Qualified Health Center

DP064: Hospital Committees: Do Resident Perceptions of Active Participation Change Over the Course of Their Residency

DP065: Development of Medical Spanish Curriculum in Primary Care Residency Program

DP066: Asthma Visits: Using Planned Care to Improve Quality and Patient Activation

DP067: Developing a Hybrid FM/IM Hospitalist Model of Inpatient Care in an Academic Family Medicine Residency

DP068: Medical Student Perceptions of Wellness: A Photo-Elicitation Study

DP069: Implementation of a Longitudinal Family Planning Curriculum in the Drexel Family Medicine Residency Program

DP070: Realignment of an Established Faculty Development Program for New Teachers: A Systematic Approach

DP071: Better Together: Multidisciplinary Group Visits for Diabetes Management

Monday, April 29: 10–11 am

Room: Osgoode Ballroom

Developing Scholarly Project Posters cont.

DP072: Implementing a Precepting Chart Audit: Improving Quality of Care and Supervision

DP073: They Treat Me Nice in the ER—ER Utilization Among Patients at an Urban Federally Qualified Health Center

DP074: Exploring Resident Perspectives on Incorporating Integrative Medicine Curriculum Into Family Medicine Residency

DP075: Refugee Shelter Outreach Program: Medical Student Community Service Learning

DP076: Accessing Wellness: Review of Mobile Apps for Low-Income Diverse Patient Population

DP110: Implementation of Resident-Driven Group Visits for Diabetic Patients at Drexel Family Medicine as a Tool for Teaching Residents and Medical Students

Monday, April 29: 10–11 am

Room: Osgoode Ballroom

Fellows, Residents, or Students Research Works-in-Progress Posters

FP52: What's Your Status? A Study of Patient Education Regarding Code Status in the Primary Care Setting

FP53: The Use of a Map to Increase Diabetic Retinal Screening Rates at the UNC Family Medicine Center

FP54: Introduction of Solid Food to Infants at a Family Medicine Residency Clinic in Rhode Island

FP55: Understanding the Experience of IUD Self-Removal Through a Qualitative Analysis of Internet Posts

FP56: Evaluating the Implementation and Effects of a Novel Curriculum for Residency Sick Call

FP57: Evaluation of a Resident-Led Breastfeeding Curriculum for Family Medicine Residents at a Federally Qualified Health Center

FP58: Brown Advocates for Social Change and Equity (BASCE): A Leadership Program to Combat Structure Racism

FP59: Improving Outcomes for Asplenic Patients

FP60: Variability in Hepatitis C Screening in Two Community Clinics: Impact of Provider Role and Time of Day

FP61: A Qualitative Study on Students' Perceptions of Intellectual Stimulation in Family Medicine in Canada and the UK

FP62: Evaluation of a Geriatric Correctional Insulin Scale in Patients With Diabetes

FP63: Increasing Minority Presence in Medicine: A Pipeline Project With PVHMC and Bright Prospect

FP64: Medical Student Knowledge of the Patient's Medical Home: A Qualitative Study

FP65: Madsen Family Medicine Clinic Breast Cancer Screening

FP66: Integrating Resident and Medical Student Quality Improvement Curricula at a Teaching Health Center

FP67: Physician Attitudes Towards Integrative Medicine and Specific Alternative Therapies

FP69: Experience and Training With Postplacental Intrauterine Device Placement Among Family Medicine Residents and Faculty

FP70: Optimizing Care of the Chronic Pain Patient

FP71: Effect of Training Curriculum on Intern Physicians' Comfort in Performing Patient Care Tasks in an Electronic Medical Record

FP72: Screening for Kidney Damage in Diabetic Patients: A Resident-Led Quality Improvement Initiative Leads to System Change

FP73: Effects of a Health Curriculum in Knowledge and Attitudes Toward Healthy Living of Students at a Safety-Net High School

FP74: Assessment of Barriers to Implementing Group Quality Improvement Projects in a Family Medicine Residency Program

FP75: Dual-Agent Induction and Its Effect on Duration and Complications of Labor: A Retrospective Analysis

FP76: Evaluation of a Residents as Teachers Curriculum on Resident Teaching Confidence and Comfort

FP77: The Impact of Block Scheduling on Residency Quality and Resident Satisfaction

FP78: Crafting an Obesity Management Curriculum at an Urban Family Medicine Residency

Monday, April 29: 10–11 am**Room: Osgoode Ballroom****Fellows, Residents, or Students Research Works-in-Progress Posters cont.**

FP79: Assessing Family-Centered Attitudes and Skills of Family Medicine Residents Associated With a Family Skills Curriculum

FP80: Impact of Pharmacist Involvement in Interdisciplinary Transitions of Care in a Family Medicine Residency Clinic

FP81: Cook County Medical Examiner and Health System Data Linkage Informing Overdose Prevention Strategies

FP82: A Medicaid Dichotomy: The Impact of the Implementation of the Affordable Care Act on Preconception Care

FP83: Effect of Prepregnancy Insurance on Timing of Prenatal Care Initiation: A Study of the 2009–2015 National PRAMS Database

FP84: Survey of Asthma Prevalence and Severity in a Pediatric Population Residing With a Parent/Guardian at the Open Door Mission

FP85: Improving Hospital Discharge Efficiency Through Resident-Pharmacist Collaboration

FP86: Improving Residents' Attitudes and Knowledge of Health Equity Through a Dedicated Curriculum

FP87: Universal Screening for Gonorrhea and Chlamydia In Female Patients Ages 15–24 Years

FP88: No Change in Condom Use Before and After Long-Acting Reversible Contraception (LARC) Initiation in Adolescent Females

FP89: Evaluating the Effectiveness of Medical Students in Helping Patients Quit Smoking in a Student-Run Free Clinic

FP90: HPV Vaccination Rates Among Family Medicine Practice Patients: Do Patient Characteristics Play a Role?

FP91: The Effects of Gestational Diabetes on Depression in Pregnancy

FP92: Plugged In: Investigating Pediatric Screen Time Use in a Primary Care Setting

FP93: Analyzing Medically Complex Patients With Unmet Social Needs

FP94: Assessing Leadership Readiness and Quality Improvement Teamwork Among Family Medicine Residents—A Mixed-Methods Analysis

FP95: Family Strain Impacts Severity of New Chronic Pain for Midlife Adults

FP96: Resident Education in Skin Cancer Prevention and Self Screening Exams Will Lead to an Increase in Patient Education

FP97: A Simple One-Page Handout Can Improve Colorectal Cancer Screening Rates in a Family Medicine Residency Clinic

FP98: Supporting the Families of Women Impacted by the Opioid Crisis in Pennsylvania: A Model for Medical Student Advocacy

FP99: Evaluating the Impact of Medical Student Participation in a Smoking Cessation Program for Homeless Adults

FP100: Health Disparities in Cesarean Delivery Rates at a Suburban Community Hospital

FP101: CPC+: Integrating Behavioral Health Services to Support Management of Patients With Poorly Controlled Diabetes

FP102: Impact of Spanish Language Concordance on Length of Time to Diagnostic Colonoscopy After a Positive Screening Test

FP103: An Interdisciplinary Approach to Improving Well-Child Care (WCC) up to five Years at a University-Based Family Practice Clinic

FP104: Poorly Controlled Depression and Diabetes

FP105: Evaluating Current Needs and Opportunities for Integrating Primary Care, Research and Public Health in Faculty Development

FP106: Contraception Initiation and Continuation After Early Abortion in a Family Medicine Setting

Tuesday, April 30: 10–11 am

Room: Osgoode Ballroom

Completed Research Posters

RP27: Exploring the Impact of Group Size on Medical Students' Perception of Learning and Professional Development During Clinical Rotations

RP28: Patient Perspectives on Using Shared Decision Making in Diabetes Prevention: A Pharmacist-Delivered Intervention Among Spanish and English Speaking Latinos in the Saftey Net

RP29: Should Primary Care Providers Discuss Social Media Use With Patients? #maybe: A Randomized, Controlled Pilot Study

RP30: Advance Directives: Resident and Patient Perspective in a Family Practice Setting

RP31: Family Physicians' Knowledge of and Perceptions on Marijuana Use

RP32: Seeking Objective Measures of Resident Fatigue

RP33: Timeliness of HbA1c Testing in Patients With Diabetes in an Urban Family Medicine Private Practice

RP34: Patient-Centered Care Specific to Treatment of Substance Misuse and Mental Health Conditions: An Examination of Trends in Data From a Family Medicine Residency Program

RP35: Beyond Prescribing: Patient Surveys Reveal Need for Communication Training for Residents Specific to Chronic Pain Management

RP36: Can an International Training Program Strengthen Family Medicine and Primary Care Across Borders? An Evaluation of a Toronto-Based Program Aimed at Strengthening Family Medicine and Primary Care

RP37: An Interprofessional Approach to Screening, Brief Intervention, and Referral for Treatment (SBIRT) Education

RP38: Knowledge and Application of International Electrocardiography Criteria in Family Medicine Residency

Tuesday, April 30: 10–11 am

Room: Osgoode Ballroom

Completed Scholarly Project Posters

CP24: Assessing Facilitators and Barriers of Faculty Teaching Ethics in Family Medicine

CP25: A Successful Introduction of a Wide Variety of Technologies Purposefully Prepares Faculty to Teach Good Patient Care

CP26: Human Immunodeficiency Virus (HIV): Increasing Screening and Identifying Risk Factors

CP27: Revitalizing Morning Report to Improve Learning, Participation, and Attendance by Residents and Faculty

CP28: How a 'Women in Medicine' Support Group Can Empower and Mentor Female Resident Physicians

CP29: Quality Assessment of Interprofessional Care Clinic Educational Experience on Team Readiness Over Time

CP30: Climbing up the Ladder of the Education and Practice Integration Continuum: An Evaluation of the Uptake of Behavioral Health for Patient Care in a Family Medicine Residency

CP31: Family Medicine Residents Addressing Disparities in the Health Workforce Pipeline

CP32: A PGY-3 Global Health and Vulnerable Populations Enhanced Skills Program Follow-Up Study: Graduates and Beyond

CP33: Reducing HIV Risk Through Integrated Substance Use Disorder Treatment: A Comparison of Health-Related Outcomes

CP34: Assessing Local Barriers to Advance Care Planning in an Academic Medical Group

Tuesday, April 30: 10–11 am

Room: Osgoode Ballroom

Developing Scholarly Project Posters

DP077: What Do Primary Care Physicians and Dentists Know, Think About and Do in Regards to Oral Health?

DP078: What Can Medical Students Learn About Oral Health During a Health Equity Clerkship?

DP079: Rethinking the Core Skills of Residency—Part 2

DP080: Destigmatization of Organ Donation in the African American Community Through the Use of Social Media

DP081: Stethoscope Hygiene Practices at Penn State Health Family Medicine Clinic

DP082: Development of a Sustainable, Interdisciplinary Global Health Track for Family Medicine Residents

DP083: Staying WELL Within ACGME Requirements

DP084: Bronx-Yuma: A Collaborative to Help “Transplant” a Prehealth Pipeline Program

DP085: Documenting DNR Status Outside of the EMR to Improve Patient Safety and Satisfaction

DP086: Implementation of a Novel Curriculum for Dermoscopy Training in an Academic Family Medicine Residency: Methods and Process

DP087: Our Patient Empanelment and Access Journey as a Rural FMC

DP088: Implementing a Longitudinal Behavioral Medicine Curriculum for FM Residents

DP089: Does Race Impact Student Evaluations of Teaching Effectiveness

DP090: The Development of Curriculum in Caring for Underserved Patients for First- and Second-Year Medical Students

DP091: How We Created a Well-Coordinated, Integrated System to Treat OUD With B/N From the ED to Outpatient Setting: Lessons Learned Along Our Journey

DP092: Residents’ Attitudes and Intention to Practice Maternity Care: A Preliminary Longitudinal Evaluation of an Intern OB Bootcamp

DP093: WE for Wellness

DP094: Better Together: Paired Expert Consultations With a Family Medicine Clinician and Education Scientist Promote Educational Scholarship Among Widely Distributed and Diverse Family Medicine Clinical Faculty

DP095: Utilization of an OSCE to Determine Resident Readiness to Become a Senior Resident

DP096: Safe Prescribing of Opioids at Barre Family Health Center

DP097: Experiences of Learners and Program Directors in Accelerated Medical School Curricula

DP098: Physician-Nurse Education and the Effect of Bias on HPV Vaccination in Two Rural Family Medicine Clinics

DP099: Transforming a Traditional Suburban Family Medicine Residency Into a Community Medicine Program With an Urban Underserved Focus

DP100: Addressing Population Health Competencies Through Intervention Mapping: A Program Planning Framework

DP101: Utilizing Telemedicine for Diabetes Education in the South Bronx

DP103: Implementation of an Integrative Medicine-Based Resident Wellness Curriculum in a Community-Focused Family Medicine Residency

DP104: The Intersection of Trauma-Informed Physical and Psychological Management of Chronic Pain

DP105: BEDSIDER Patient-Friendly Contraception Postcards: Do They Work to Educate Patients?

DP106: Residency Day One: Stop Shadowing, Start Leading

DP108: COPE (Chronic Opioid and Pain Education): Implementing a Chronic Pain Group Visit in a Federally Qualified Health Center Residency Clinic

DP109: Primary Care Endoscopy Training in Rural Montana

DP111: Advancing Family Medicine Resident Competency in Mental and Behavioral Health Through an Innovative Partnership Strategy

DP112: Premedical Students as Scribes: An Undergraduate Clinical Internship to Improve Office Efficiency and Promote Interest in Family Medicine

DP113: Implementation of Cognitive Behavioral Therapy for Insomnia at a Residential Drug and Alcohol Rehabilitation Center

Tuesday, April 30: 10–11 am

Room: Osgoode Ballroom

Fellows, Residents, or Students Research Works-in-Progress Posters

FP21: Use of the Centering Pregnancy Initiative to Decrease Preterm Birth and Racial Disparities in a High-Risk Population

FP107: Resident-Led Interdisciplinary Team Approach to Health Education and Self-Management in High-Risk COPD Patients in FMC

FP108: Quality Control Weight Study

FP109: Guided Imagery and Stress Reduction in Adolescents

FP110: Hepatitis C Screening Rates at Farrell Family Medicine Community Health Center: A Resident-Driven Quality Improvement Project

FP111: Are Residents at the CHRISTUS Health/Texas A&M Family Medicine Residency Program Practicing Safe Opioid Prescribing?

FP112: A Geo-Spatial Analysis of Type 2 Diabetes Mellitus Control in a South Texas Family Medicine Clinic Population

FP113: A Process for Deprescribing With Elderly Patients

FP114: Evaluation of Covisits Between Family Medicine Residents and Mental Health Clinician Trainees at a Boston VA Hospital

FP115: Implementation and Evaluation of Social Needs Screening in a Large Safety-Net Family Medicine Clinic and Residency Program

FP116: From Burnout to Resilience: CERA Survey of Well-Being in Family Medicine Residency

FP117: Determining the Best Approach to Resident Education in Addiction Medicine

FP118: Improving Diabetic Retinopathy Screening in a Large Ambulatory Practice

FP119: Differences in Rates of Blood Transfusion Among Rural, Texas Women Delivering in Rural vs Urban Hospitals

FP120: Improving Patient Safety Through Utilization of the I-PASS Handoff

FP121: Golden Letter: Innovative Collaboration to Reduce Avoidable Hospital Admissions

- FP122:** Improving Interprofessional Collaboration: Diabetes and Behavioral Health Referrals in a Family Health Center
- FP123:** Showing Up: A Quality Improvement Project to Improve Missed Appointment Rates at an Urban Family Medicine Residency Clinic
- FP124:** Influenza and Pneumococcal Vaccination in the Geriatric Population: Examining Attitudes and Improving Immunization Rates
- FP125:** Teaching as Exam Preparation: Using Adult Learning Principles in Interactive Resident-Led Board Review Sessions
- FP126:** Mass and Effect: Body Mass Index as Predictor of Obstetrical and Neonatal Outcomes
- FP129:** Does Lack of Documentation on a Problem List for Common Obstetric or Medical Issues Lead to Gaps in Care or Communication?
- FP130:** Improving Completion of Ages and Stages Questionnaires in a Federally Qualified Health Center
- FP131:** Teen Clinic: Understanding Common Beliefs Surrounding Sexual/ Reproductive Health at the First Choice South Valley Clinic
- FP132:** Exercise Benefits and Safety Beliefs in Urban Pregnant Women
- FP133:** Demystifying Motivational Interviewing: Building A Practical Curriculum for Family Practice Residencies
- FP134:** Evaluation of Potential Barriers to Care for Treatment of Hyperlipidemia in Amish Patients With Identified ApoB Mutations
- FP135:** Does Adapting Obstetric Call to Improve Resident Well-Being Effect Patient Continuity?
- FP136:** A Pilot Project to Study the Feasibility of a Phone Call intervention to Improve Postpartum Visits Rates

Tuesday, April 30: 10–11 am**Room: Osgoode Ballroom****BFEF Fellows Posters**

BP01: Development of a Reference Quick Guide for Suicide Assessment in Primary Care

BP02: Developing a Scale to Evaluate Residents' Professionalism Within Military Medicine

BP03: Assessing Attitudes and Barriers in Residents' Management of Chronic Suicidality

BP04: Upfront Agenda Setting Skills Training: Improving Residents' Efficiency and Satisfaction

BP05: Patient Care Is a Partnership: Assessing a Curriculum Change on Patient-Centered Communication Skills

BP06: Teaching the ETHNICS Mnemonic to Family Medicine Residents: A Framework for Providing Culturally Informed Care

BP07: Brief Behavioral Intervention Skills for Family Physicians

BP08: Interdisciplinary Training in Screening, Brief Intervention, and Referral to Treatment (SBIRT) in Rural Family Medicine

BP09: Development and Implementation of a Motivational Interviewing Skills Training and Evaluation Program

BP10: Encouraging a Culture of Wellness in a Family Medicine Department Using the PERMA Profiler

BP11: Evaluating the Integrated Behavioral Health Expansion Within a Family Medicine Residency Program

BP12: Fostering Resilience in Family Medicine Interns: Evaluating a Workshop Series

BP13: Effects of Behavioral Medicine Rotation on Perceived Behavioral Medicine Skills and Clinical Documentation of Suicidality

BP14: Gratitude Journaling in Family Medicine Residency: An Innovative Approach to Increasing Psychological Well-Being

BP15: Integration of Narrative Medicine as a Tool for Reflection in a Family Medicine Residency

BP16: Resident Cultural Understandings of Stigma in Weight Management Counseling

BP17: Faculty Development Related to LGBTQ Health: What Does It Mean to “Get on the Same Page?”

Tuesday, April 30: 10–11 am

Room: Osgoode Ballroom

Emerging Leaders Fellows Posters

EP01: Creating a Chief Resident Leadership Curriculum—Leadership Lessons Learned

EP02: Leadership Development Through Inpatient Clinical Transformation Project

EP03: Restructure of Faculty Development and Initiation of a Junior Faculty Development Program at a Community-Based Residency Program

EP04: Design and Implementation of a Community Health Education Curriculum in a Family Medicine Residency Program

EP05: Creating an Annual Regional Family Medicine Research Symposium

EP06: Preparing Residents for Medicine in the Military

EP07: Strengthening Culture Through Core Values

EP08: Taking It to the MAT: Developing Medication Assisted Treatment Program for Perinatal Patients

EP09: Making FMRP Curriculum Changes From an Emerging Leader’s Perspective

EP10: Integrating Chronic Care Management Into a Family Medicine Residency Clinic

EP11: Developing and Implementing a Point-of-Care Ultrasound Curriculum for a Family Medicine Residency Program

EP12: Forming an Osteopathic STFM Collaborative: A Journey in Leadership

EP13: Oh! The Places You’ll Go! Leadership Lessons Learned Through the Evaluation and Implementation of a Health Disparity-Related Residency Curriculum

EP14: EPAs vs Milestones: How to Improve Resident Evaluations

EP15: What Does It Take? How We Improve Clinical Workflows Through a Team-Based Approach at the Barre Family Health Center

STFM Collaborative and Special Project Team Meetings



Attend any meetings of the STFM Collaboratives and Special Project Teams to learn more about how you can get involved in our many STFM projects.

Monday, April 29

7:15–8:15 am

Room: Grand Ballroom

Common Interest and Networking Discussions With Continental Breakfast

The following STFM Collaboratives and STFM Special Project Teams will meet to discuss topics of common interest to STFM members. These meetings are open to all interested individuals.

STFM Collaboratives:

1. Abortion Training and Access
2. Family Centered Maternity Care
3. HIV and Viral Hepatitis
4. LGBTQ Health
5. Oral Health
6. Primary Care and Public Health Integration
7. Women in Family Medicine

Special Project Team:

8. Health Policy and Advocacy
9. Immunization Education

Other:

- 10–11. First-Time Conference Attendees' Networking Tables

Monday, April 29

12:30–1:30 pm

Meetings of STFM Collaboratives With Boxed Lunch (Pick up your boxed lunch in the Grand Ballroom before heading to all of your desired meetings.)

The following STFM Collaboratives will meet to discuss topics of common interest to STFM members. These meetings are open to interested individuals.

Abortion Training and Access

Room: Forest Hill

Addictions

Room: Sheraton Hall B

Care of Infants and Children

Room: Kenora

Evidence-Based Medicine

Room: Churchill

Ethics and Humanities

Room: Dufferin

Faculty Development

Room: Civic Ballroom South

Family and Behavioral Health

Room: MacKenzie

Family Centered Maternity Care

Room: Sheraton Hall A

HIV and Viral Hepatitis

Room: Danforth

Hospital Medicine and Procedural Training

Room: Provincial South

LGBTQ Health

Room: Leaside

Medical Education Best Practices

Room: City Hall

Medical Student Education

Room: Civic Ballroom North

New Faculty in Family Medicine

Room: Wentworth

Nutrition Education

Room: Sheraton Hall C

Osteopathic

Room: Kensington

Persons and Physicians With Disabilities

Room: Elgin

Pharmacist Faculty

Room: Yorkville West

Practice Management

Room: Kent

Primary Care and Public Health Integration

Room: Simcoe

Professional Well-Being

Room: Dominion South

Rural Health

Room: Huron

Women in Family Medicine

Room: Dominion North

Tuesday, April 30

12:30–1:30 pm

Optional Meetings of STFM Collaboratives and Special Project Teams (Lunch is on your own.)

The following STFM Collaboratives and Special Projects Teams will meet to discuss topics of common interest to STFM members. These meetings are open to all interested individuals.

Abortion Training and Access

Room: Elgin

Faculty Development

Room: Civic Ballroom North

Family Centered Maternity Care

Room: Provincial South

Global Health Educators

Room: Provincial North

Primary Care and Public Health
Integration

Room: Sheraton Hall A

Women in Family Medicine

Room: Sheraton Hall C

Special Project Team:

Group Medical Visits

Room: Sheraton Hall B

General Conference Information



Conference Hotel

Sheraton Centre Toronto Hotel
123 Queen Street W
Toronto, Ontario M5H 2M9 Canada
Phone: 416-361-1000

Ground/Shuttle Transportation

Various transportation options are available from area airports to the Sheraton Centre Hotel. The hotel does not provide shuttle service to/from airports. *Note: All prices listed are in Canadian dollars.*

From Pearson International Airport:

Public Transit: http://ttc.ca/Riding_the_TTC/Airport_service.jsp

Fare information: http://ttc.ca/Fares_and_passes/Prices/index.jsp

UP Express Shuttle: \$24.70 round-trip. UP Express connects Toronto Pearson International Airport to Union Station in just 25 minutes. Trains leave every 15 minutes. First train departs Pearson Station at 5:27 am and the last train departs at 12:57 am. Directions to the Sheraton Centre Hotel Toronto from UP Union Station: head north on York street. The hotel will be on the east side of York Street between Richmond and Queen Streets (just four blocks north of Front Street).

Taxi and Limo: \$50.00–\$55.00 one way (approximately)

Uber/Lyft: <https://uber.com/en-CA/airports/yyz/>

Transfer services by limo, taxi or Uber/Lyft are approximately 30–45 minutes.

From Billy Bishop City Airport:

Complimentary Shuttle: Shuttle drops off at Front and York Streets, then it's a 10–12 minute walk to the Sheraton Centre.

Public Transit: After exiting airport walk to Queens Quay West (approximately 3 minutes) and take TTC Street Car (trolley cars) to Union Station. From Union Station, it's a 10–12 minute walk to the Sheraton Centre. By underground train, it's two stops.

Fare information: http://ttc.ca/Fares_and_passes/Prices/Prices.jsp.

Taxi: \$15.00 (approximately). Taxis are readily available at the main exit after crossing via the tunnel walkway or by ferry.

Uber/Lyft: <https://uber.com/en-CA/airports/ytz>

Transfer services by taxi or Uber/Lyft are approximately 15–20 minutes.

Continuing Education

This Live activity, 52nd STFM Annual Spring Conference, with a beginning date of 04/26/2019, has been reviewed and is acceptable for up to 30.75 Prescribed credit(s) by the American Academy of Family Physicians. Physicians should claim only the credit commensurate with the extent of their participation in the activity. Preconference activities on April 26-27 are included in these credit hours.

The following sessions are not eligible for CME credit due to not supporting the physician's role to deliver patient care: Sweet Mindfulness: A Chocolate Tasting, Spark Connection: A Quick Way for Underrepresented in Medicine Faculty to Expand their Professional Support Network and Contacts, Escaping the Average Teaching Technique: First Solve and Then Build an Escape Room!, Presentation Skills Revamped: How to Take Your Presentation to the Next Level, How to REALLY Take Time Off From Work, Speed Group Mentoring for Women Physicians, Pursuing Scholarship: Creating Effective Conference Submissions, Getting Ready to Leap: Preparing Midcareer Faculty to Take the Next Career Step Approaching Faculty Retirement, and Parental Leave in Residency: Creating a Formal Parental Leave Policy.

AMA/AAFP Equivalency

AAFP Prescribed credit is accepted by the American Medical Association as equivalent to AMA PRA Category 1 credit(s)TM toward the AMA Physician's Recognition Award. When applying for the AMA PRA, Prescribed credit earned must be reported as Prescribed, not as Category 1. CME activities approved for AAFP credit are recognized by the AOA as equivalent to AOA Category 2 credit. AAFP Prescribed credit is accepted by the following organizations. Please contact them directly about how you should report the credit you have earned. American Academy of Physician Assistants (AAPA); National Commission on Certification of Physician Assistants (NCCPA); American Nurses Credentialing Center (ANCC); American Association of Nurse Practitioners (AANP); American Academy of Nurse Practitioners Certification Program (AANPCP); American Association of Medical Assistants (AAMA); American Board of Family Medicine (ABFM); American Board of Emergency Medicine (ABEM); American Board of Preventative Medicine (ABPM); American Board of Urology (ABU).

CEU Credits

Behavioral science professionals attending this year's conference may request a tracking form and instructions at the STFM registration desk to track educational sessions they attend that may qualify for CEU credit with their independent state licensing boards. Additional session information sometimes required by state licensing boards will be available online at stfm.org/annual.

Registration Refund Policy

If a registrant cannot attend a conference for personal or work reasons, requests for refunds must be received by STFM in writing by April 1 to receive a 50% registration fee refund. No refunds will be issued after April 1 except for those emergencies addressed below:

Refund requests due to medical or weather emergencies at time of conference may be eligible for a 50% refund. If registrant is unable to attend because of a weather emergency, registrant must show that they attempted to reschedule their travel arrangements but could not get to the conference during the official conference dates. In the event of such cancellation request by a conference registrant, the registrant must provide STFM with official documentation to support their request. In the unlikely and extreme event that STFM is forced to cancel a conference, STFM is not responsible for fees or penalties that conference registrants may incur for non-refundable airline tickets or hotel deposits.

Photo/Video Permission

We will be taking photos and video throughout this conference. By attending the conference, you give STFM permission to use images taken at the conference in any electronic or printed communications by STFM for any advertising and promotional purposes. You agree to release STFM and their employees, agents, and designees from liability for any violation of any personal or proprietary right you may have in connection with such use.

Sheraton Centre Toronto Health Club

The Sheraton fitness facilities include cardiovascular equipment and free weights complimentary to all guests, and are accessible 24-hours a day with a room key. The hotel also features indoor and outdoor pools.

Mother's Room—*New Offering!*

A convenient lactation room will be available to all conference attendees. Moms needing a private, safe space to nurse and/or pump can access the room during conference hours on Saturday, Sunday, Monday, and Tuesday. The lactation room includes private curtained areas with chairs, tables, and electrical outlets. Please note that pumps will not be provided.

Room: Yorkville East

Need More Information or Have Questions?

Please visit with staff at the STFM registration desk located in the Grand Ballroom Foyer.

LOWER CONCOURSE

Rm	Name
1	GRAND BALLROOM
2	GRAND WEST
3	GRAND CENTRE
4	GRAND EAST
5	GRAND EAST (LARGE)
6	GRAND BALLROOM FOYER
7	VIDE OFFICE
8	VIDE
9	SHERATON HALL A
10	SHERATON HALL B
11	SHERATON HALL C
12	SHERATON HALL D
13	SHERATON HALL E
14	SHERATON HALL F
9-14	SHERATON HALL
15	OSGOODE FOYER
16	OSGOODE BALLROOM WEST
17	OSGOODE BALLROOM EAST
16-17	OSGOODE BALLROOM

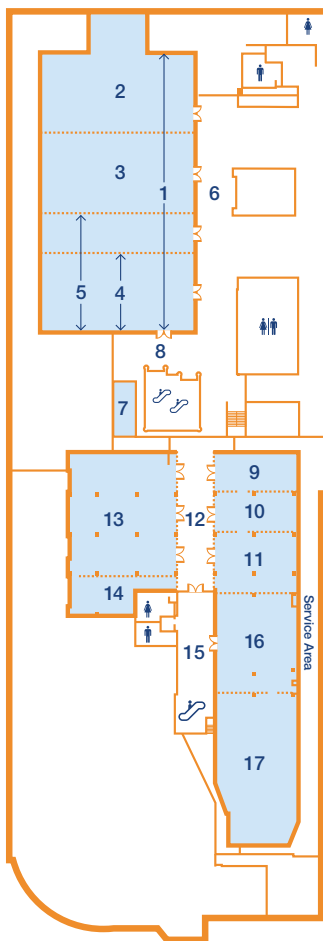

SECOND FLOOR

Rm	Name
42	DOMINION BALLROOM N.
43	DOMINION BALLROOM S.
42-43	DOMINION BALLROOM
44	ROOSEVELT
45	MACKENZIE
46	CHURCHILL
47	CITY HALL
48	PROVINCIAL BALLROOM N.
49	PROVINCIAL BALLROOM S.
48-49	PROVINCIAL BALLROOM
50	ELGIN
51	WENTWORTH
52	KENORA
53	HURON
54	KENT
55	SIMCOE
56	DUFFERIN
55-56	SIMCOE & DUFFERIN
57	CIVIC FOYER
58	CIVIC BALLROOM N.
59	CIVIC BALLROOM S.
58-59	CIVIC BALLROOM
60	WATERFALL GARDEN

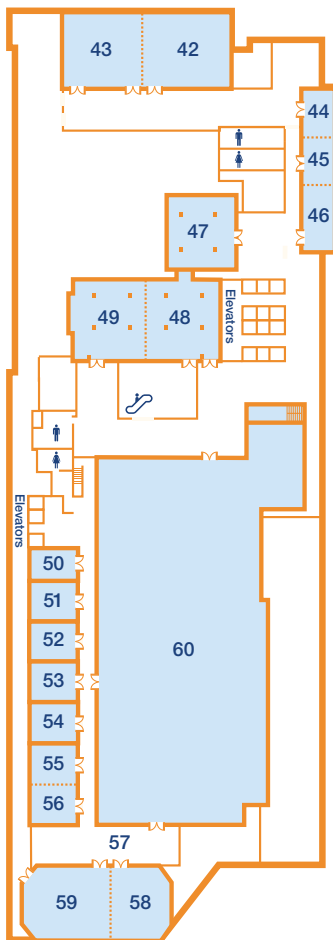

FOURTH FLOOR

Rm	Name
61	LEASIDE
62	ROSEDALE
63	FOREST HILL
64	KENSINGTON
65	DANFORTH
66	DAVENPORT
67	YORKVILLE EAST
68	YORKVILLE WEST

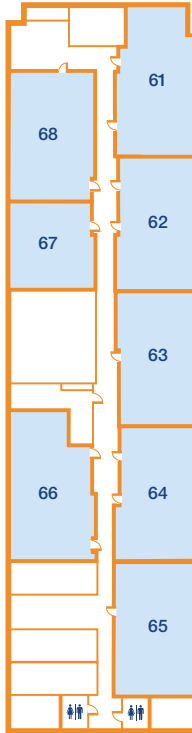

Thanks and Recognition

STFM Program Committee

Andrea Pfeifle, EdD, chair
Indiana University

Maria Gabriela Castro, MD
University of North Carolina

Edgar Figueroa, MD, MPH
Weill Cornell Medicine

Tina Kenyon, MSW
New Hampshire-Dartmouth FMR

Amy Odom, DO
Sparrow Hospital/Michigan State University

Jeffrey Ring, PhD
Health Management Associates, Burbank, CA

Netra Thakur, MD
*Advance Community Health
Center, Raleigh, NC*

Daisuke Yamashita, MD
Oregon Health & Science University

STFM Research Committee

Tammy Chang, MD, MPH, chair
University of Michigan

Alicia Agnoli, MD, MPH, MHS
University of California Davis

James Beal, PhD
*University of North Dakota School of
Medicine and Health Sciences*

John Epling, Jr, MD, MEd
*Carilion Clinic and Virginia Tech,
Carilion School of Medicine*

Alesia Jones, PhD
*University of Illinois College of
Medicine at Rockford*

Jody Lounsbery, PharmD
*University of Minnesota - North
Memorial Hospital*

Amanda Kost, MD
University of Washington

Caitlyn Rerucha, MD
Carl R. Darnall Army Medical Center

For a list of the STFM Board of Directors and all STFM Committees, visit stfm.org/about/governance/boardofdirectors/boardofdirectors/ and stfm.org/about/governance/committees/committees/

Special thanks to the College of Family Physicians Canada and the University of Toronto for their support and contributions in planning this year's conference.

Thanks to the College of Family Physicians Canada for their support of the 2019 STFM Foundation Fun Run/Walk.

53rd STFM Annual Spring Conference

- Call for presentations will open in late June -
stfm.org/annual

May 2-6, 2020 • Salt Lake City, UT



STFM would like to acknowledge and thank our 2019 conference partners!

Elite Partner



National Institute on Drug Abuse (NIDA)
Clinical Trials Network (CTN) Dissemination Initiative

Conference Partners



Banner
University Medical Group

LIFEPPOINT
HEALTH®

MAYO
CLINIC



dermlite

CONCORD HOSPITAL
Medical Group



SCHOOL OF MEDICINE
Family Medicine



RHEDI
Mainstreaming Abortion
In Family Medicine

Dignity Health.
Methodist Hospital of Sacramento

PROMEDICA

Family Medicine Residency Program
Human Trafficking Medical Safe Haven

PennState Health
Milton S. Hershey Medical Center

CASE
NETWORK

EBSCO Health



THE UNIVERSITY OF ARIZONA
Center for
Integrative Medicine